

# PowerShot S2 IS SYSTEM MAP

DIGITAL CAMERA

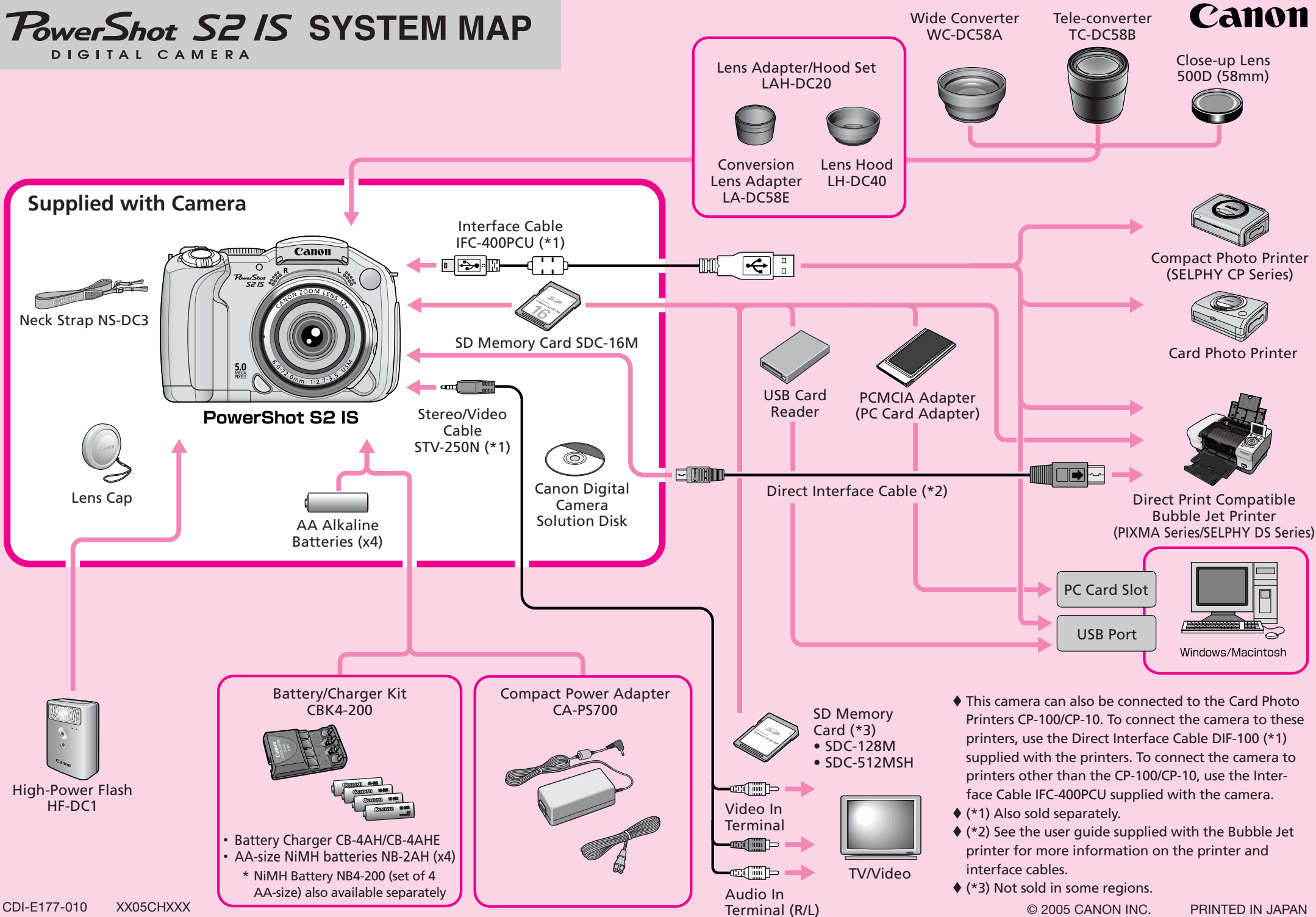

◆ This camera can also be connected to the Card Photo Printers CP-100/CP-10. To connect the camera to these printers, use the Direct Interface Cable DIF-100 (\*1) supplied with the printers. To connect the camera to printers other than the CP-100/CP-10, use the Interface Cable IFC-400PCU supplied with the camera.

◆ (\*1) Also sold separately.

◆ (\*2) See the user guide supplied with the Bubble Jet printer for more information on the printer and interface cables.

◆ (\*3) Not sold in some regions.

## Confirming the Package Contents

Your camera package includes all of the following items. If any of these items are missing, please contact the dealer for assistance.

- Digital Camera
- Lens Cap
- Neck Strap NS-DC3
- AA Alkaline Batteries (x4)
- SD Memory Card SDC-16M
- Interface Cable IFC-400PCU
- Stereo/Video Cable STV-250N
- Canon Digital Camera Solution Disk
- Quick Start Guide
- Camera User Guide
- Direct Print User Guide
- Software Starter Guide
- "For Windows® XP and Mac OS X Users" Leaflet
- System Map (this sheet)
- "Canon Customer Support" Leaflet
- Warranty Card

## Optional Accessories

The following camera accessories are sold separately. **Some accessories are not sold in some regions.**

### Lenses, Lens Adapter

- **Lens Adapter/Lens Hood Set LAH-DC20**  
This conversion lens adapter and hood set is required for mounting the wide converter and tele-converter to the camera.
- **Wide Converter WC-DC58A**  
Converts the focal length of the body lens by a factor of approximately 0.75 (35mm film equivalent at maximum wide angle: approximately 27mm) when attached.
- **Tele-converter TC-DC58B**  
Converts the focal length of the body lens by a factor of approximately 1.5 (35mm film equivalent at maximum telephoto: approximately 648mm) when attached.
- **Close-up Lens 500D (58mm)**  
This lens can be used to take close-ups of subjects that are 35 to 50 cm (at maximum telephoto) from the lens tip.

### Flash

- **High-Power Flash HF-DC1**  
This attachable supplementary flash can be used to capture photographic subjects that are too distant for the built-in flash to illuminate.

### Power Supplies

- **Compact Power Adapter CA-PS700**  
This adapter lets you power the camera from any standard household power outlet. Recommended to power a camera for an extended period of time or when connecting to a computer.
- **Battery/Charger Kit CBK4-200**  
This dedicated battery charger kit includes both a charger unit and four rechargeable AA-size NiMH (nickel metal hydride) batteries. Convenient when taking or playing back large numbers of images.
- **NiMH Battery NB4-200**  
A set of four rechargeable AA-size NiMH batteries.

### Connection Accessories

These connection accessories can be used with computers equipped with the following OS.

Windows:	System running preinstalled Windows 98 Second Edition (SE), Windows Me, Windows 2000 Service Pack 4, or Windows XP (including Service Pack 1 and Service Pack 2).
Macintosh:	Mac OS X (v10.1.5-v10.3)* * Only systems equipped with genuine built-in USB interfaces.

- **Interface Cable IFC-400PCU**  
Use this cable to connect the camera to a computer, Compact Photo Printer (SELPHY series), Card Photo Printer (other than the CP-100/CP-10), or to a Bubble Jet printer (refer to your Bubble Jet printer user guide).

### Other Accessories

- **SD Memory Card**  
SD Memory Cards are used to store images recorded by the camera. Canon brand cards are available in 128 MB and 512 MB capacities.
- **Stereo/Video Cable STV-250N**  
Use this cable to connect the camera to a TV set (sound can be played in stereo).

## Direct Print Compatible Printers

Canon offers the following separately sold printers for use with the camera. You can produce photo quality prints quickly and easily by connecting them to the camera with a single cable and operating the camera's controls.

- **Compact Photo Printers (SELPHY series)**
- **Card Photo Printers**
- **PIXMA series printers**

For more information, visit your nearest Canon retailer.