

Canon

CANON INC. 11-28, Mita 2-chome, Minato-ku, Tokyo 108, Japan

U.S.A. ————— **CANON U.S.A., INC. HEAD OFFICE**
10 Nevada Drive, Lake Success, Long Island, N.Y. 11042, U.S.A.

CANON U.S.A., INC. MANHATTAN SERVICE STATION
600 Third Avenue, New York, N.Y. 10016, U.S.A.

CANON U.S.A., INC. ATLANTA OFFICE
6380 Peachtree Industrial Blvd., Norcross, Georgia 30071, U.S.A.

CANON U.S.A., INC. CHICAGO OFFICE
140 Industrial Drive, Elmhurst, Illinois 60126, U.S.A.

CANON U.S.A., INC. LOS ANGELES OFFICE
123 Paularino Avenue East, Costa Mesa, California 92626, U.S.A.

CANON U.S.A., INC. LOS ANGELES SERVICE STATION
3407 West 6th Street, Los Angeles, California 90020, U.S.A.

CANON U.S.A., INC. SAN FRANCISCO SERVICE STATION
776 Market Street, San Francisco, California 94102, U.S.A.

CANON U.S.A., INC. HAWAII OFFICE
Bldg. # 2, 1050 Ala Moana Blvd., Honolulu, Hawaii 96814, U.S.A.

CANADA ————— **CANON OPTICS & BUSINESS MACHINES CANADA, LTD. HEAD OFFICE**

3245 American Drive, Mississauga, Ontario L4V 1N6, Canada

EUROPE, AFRICA,
& MIDDLE EAST

CENTRAL &
SOUTH AMERICA

SOUTHEAST ASIA

ASIA/PACIFIC

CANON OPTICS & BUSINESS MACHINES CANADA, LTD. MONTREAL OFFICE

3070 Brabant Marinneau Street, St. Laurent, Quebec H4S 1K7, Canada

CANON OPTICS & BUSINESS MACHINES CANADA, LTD. VANCOUVER OFFICE

5900A, No. 7 Road, Richmond, B.C. V7C 4R9, Canada

CANON OPTICS & BUSINESS MACHINES CANADA, LTD. EDMONTON SERVICE CENTER

5222 86 St. Edmonton, Alberta T6E 5J6, Canada

CANON AMSTERDAM NV

P.O. Box 7907, 1008 AC Amsterdam, The Netherlands

CANON AMSTERDAM NV CAMERA SERVICE CENTER

Gebouw 70, Schiphol Oost, The Netherlands

CANON LATIN AMERICA, INC. SALES DEPARTMENT

P.O. Box 7022, Panama S., Rep. of Panama

CANON LATIN AMERICA, INC. REPAIR SERVICE CENTER

P.O. Box 2019, Colon Free Zone, Rep. of Panama

CANON INC. HONG KONG BRANCH

5th Floor 2-B, Fur Yiu Kok Street, Tsuen Wan, New Territories, Hong Kong

CANON AUSTRALIA PTY. LTD.

22 Lamb Road, Artarmon, Sydney 2064, Australia

PRINTED IN TAIWAN

Canon Snappy S



E
English Edition
Instructions

Thank you for buying the Snappy S. Its small size and light weight make it a wonderful companion for every activity. The lens guard that twirls open at a touch symbolizes the easy-to-use nature of the camera in general.

Film speed setting is automatic using DX coding. Your film loading worries are over because that too is automatic. As is film winding and rewinding. The camera is programmed to give correct exposure and when it is too dark, a red lamp in the viewfinder blinks to tell you to use flash. Focus is fixed so there's no trouble with out-of-focus photos.

Please spend a few minutes reading these instructions and practicing with no film in the camera. When reading this booklet unfold its front and back flaps for easy reference to the camera's parts.

Contents

Basic Operation	4
1. Loading the Batteries	5
2. Opening the Lens Cover ..	6
3. Checking the Batteries ...	7
4. Loading the Film	9
5. Shooting	14
6. Flash Photography	16
7. Automatic Rewind	18
8. Neckstrap and Case	19
9. Specifications	20
10. Care of the Camera	23

NOMENCLATURE

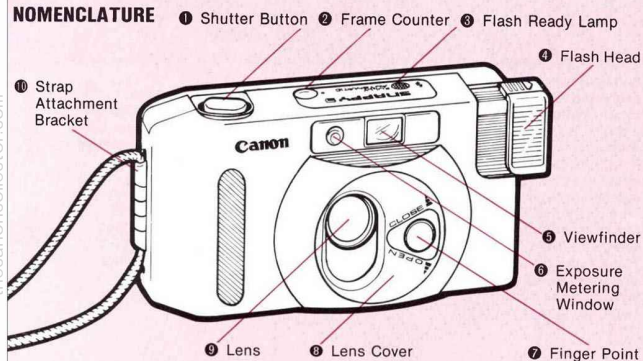

Basic Operation

1. Load the batteries.
2. Open the lens cover.
3. Check the batteries.
4. Load the film.
5. Look into the viewfinder and compose the picture as desired.
6. Press the shutter button down halfway. If the red lamp blinks, use flash.
7. Press the shutter button all the way down to take the picture.
8. At the end of the roll, the camera rewinds the film automatically. When rewind ends, remove the film cartridge and have the film developed as soon as possible.

1. Loading the Batteries

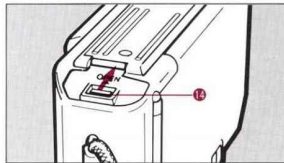

This camera will not operate without batteries. Use two new size AAA alkaline batteries of the same brand.

- Carbon-zinc batteries can also be used, but their life is shorter.
- Please do not use Ni-Cd batteries.

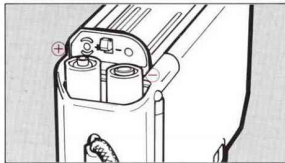

1. Open the battery chamber cover by pushing the battery chamber cover latch 14 in the direction of the arrow.
2. Load the batteries, making sure to place them in the correct \oplus \ominus order as indicated on the inside of the battery chamber cover.
3. To close the cover press it down firmly, making sure the battery chamber cover latch clicks closed.

2. Opening the Lens Cover

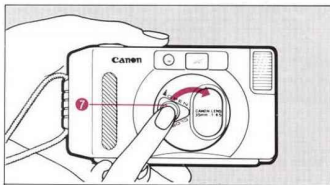

Place your finger on the finger point ⑦ and rotate the lens cover ⑧ clockwise (in the direction of the OPEN arrow).

- Shooting is impossible unless the lens cover is fully open.
- When the camera is not in use, to avoid accidentally pressing the shutter button or touching the lens, please close the lens cover.

3. Checking the Batteries

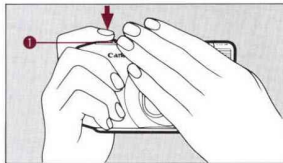

Always check the batteries before using the camera.

When checking the batteries, make sure that the flash is pushed in.

1. Cover the exposure metering window ⑥ with your hand and press the shutter button down halfway while looking through the viewfinder.

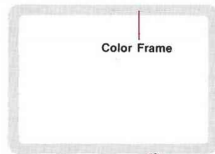

Battery Check/Use
Flash Lamp (red)



2. If the red lamp in the viewfinder blinks rapidly, battery power is sufficient.
3. If the red lamp does not light, replace both batteries with new ones of the same brand.

Battery Life (Number of 24-exp. film rolls that can be taken using new alkaline batteries.)

Normal temperature (20°C, 68°F)	About 50 rolls without flash (With flash, about 5 rolls)
Low temperature (-10°C, 14°F)	About 3 rolls without flash (With flash, about 1 roll)

The number of rolls may change depending on the batteries. These numbers are only approximations.

- If the batteries are loaded incorrectly, the lamp will not blink, so make sure they are correctly loaded.

- Battery performance is substantially reduced at low temperatures (below 0°C or 32°F). Carrying spare batteries is therefore recommended when using the camera in cold weather. Keep the camera warm until just before using it and use two sets of batteries, alternately warming each set in your pocket. Don't throw away batteries that have become unusable because of cold weather. Once they are restored to room temperature, you may be able to use them again.
- If you don't expect to use the camera for about three weeks or longer, remove the batteries so that they don't leak and corrode the camera's electrical contacts.

4. Loading the Film

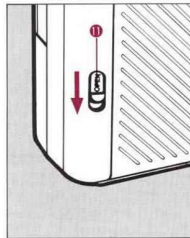

Use color or black and white negative film in standard 35mm cartridges. Load the film in subdued lighting only.

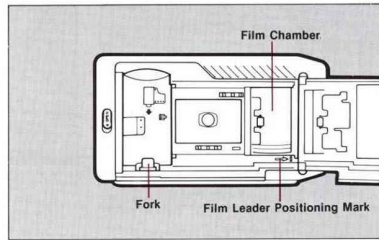

1. Press the back cover latch ❶ in the direction of the arrow to open the back cover.

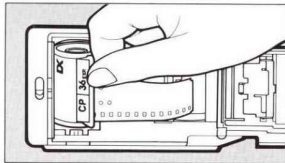

2. Insert the lower, protruding end of the film cartridge into the bottom of the film chamber first, fitting the orange fork into the film shaft. Then swing the other end of the cartridge in. The cartridge should be fully seated not tipped upward.

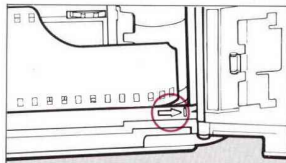

3. Pull the film leader across the back of the camera and align the tip with the positioning mark (➡) in the lower right-hand corner of the film chamber.

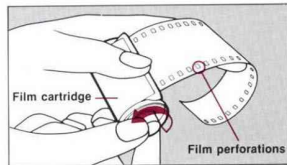

If the film leader extends past the positioning mark, manually rewind the excess film back into the cartridge.

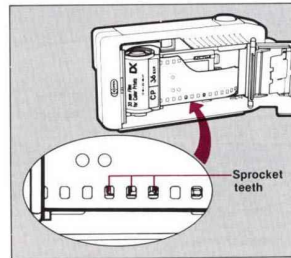

4. Make sure that the sprocket teeth are properly engaged with the film perforations, and close the back cover **18**.

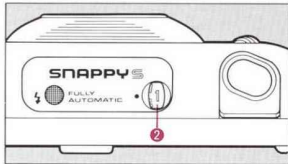

5. Press the shutter button repeatedly until "1" appears in the frame counter ②.

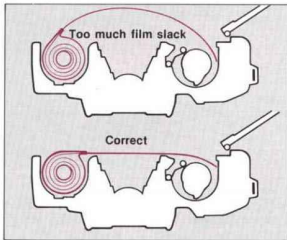

- If the frame counter does not move when you push the shutter button, the film is not being advanced. In this case, please reload the film.

thecanoncollector.com

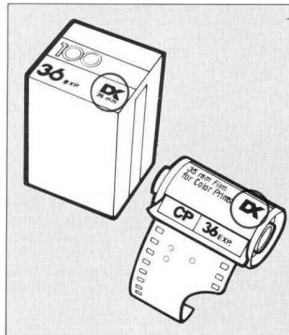

DX code film container and cartridge marked with the DX code.

This camera is designed to automatically set film speed by sensing the DX code marked on the film cassette, so you don't have to set it. The use of DX code negative film is therefore strongly recommended. The camera uses ISO 100 or ISO 400 film speeds.

(When using slide film, use ISO 100 or 400 film.)

- When film without a DX code is used, the camera will automatically set the film speed to ISO 100, so use ISO 100 film in that case.

Film passing through X-ray examinations at airports, even when loaded in a camera, may be exposed and ruined. To avoid accidental exposure, tell the inspector you want your camera and film hand checked.

5. Shooting

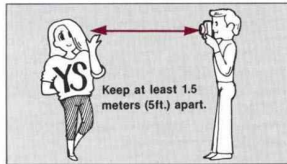

1. Align your eye with the viewfinder so that all four sides of the yellow frame inside the viewfinder appear to have equal width; then compose the picture as you desire.
2. Gently press the shutter button down halfway and check for viewfinder warnings.
3. If the red lamp is not blinking, press the shutter button all the way down to take the picture.

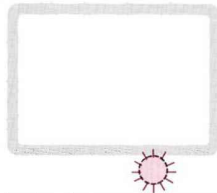

- The shooting range for the camera is from 1.5m to infinity so please get at least 1.5m (5ft.) away from your subject before you take the picture.
- If the red lamp is blinking, use flash. (For details, see page 16 about flash usage.)

thecanoncollector.com



- To hold the camera steady, keep one of your elbows pressed lightly against your body.

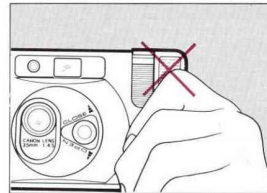

Be sure the flash, lens and exposure metering window are not blocked by your fingers or hair.

6. Flash Photography

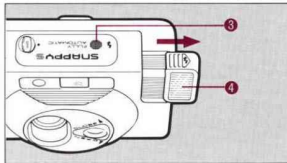

If the red lamp in the viewfinder blinks when the shutter button is pressed halfway down, switch to flash photography.

1. Pull the flash head ④ out in the direction of the arrow as far as it will go.
2. Wait for the flash ready lamp ③ to light.
3. Look through the viewfinder and frame the subject, then press the shutter button all the way down to take the picture.

—16—

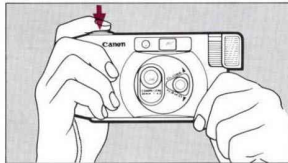

4. After the exposure is complete, always push the flash head back in. Leaving the head pulled out wastes battery energy.
- Do not press the shutter button before the flash ready lamp has come on or the picture will be underexposed (dark).
 - The flash ready lamp will not light up if you are holding the shutter button halfway down.

thecanoncollector.com

Backlit subject (daylight or dusk)



- If the shutter button is pressed halfway down after the flash ready lamp has lighted, the red viewfinder lamp will blink, but the exposure will still be correct.
- The flash exposure range when using color negative film is as follows.
ISO 100 film: 1.5m - 3.2m(5 ft.-10.5 ft.)
ISO 400 film: 1.5m - 6.4m(5 ft.-21 ft.)

Photograph made using flash



- Flash can also be used to eliminate shadows and dark faces when taking pictures of people indoors against a brightly lighted window. It can be used when shooting in the shade or in the evening. Flash is effective when used at subject distances of up to three meters (10 ft.).

—17—

7. Automatic Rewind

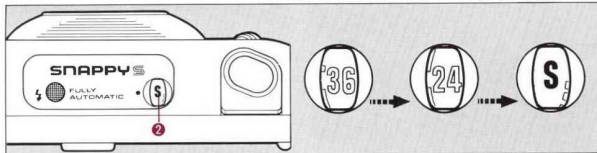

1. When the end of the film is reached, the camera will rewind the film automatically; you needn't push a single button. During rewind, the frame counter ② will count backwards.
 2. Rewind will stop automatically. After rewind is completed, check the frame counter to make sure that it is on "S".
 3. Open the back cover ⑬ and take the film out.
- Do not touch the shutter button ① while rewinding the film.
 - To rewind the film before the end has been reached, cover the lens with your hand and press the shutter button repeatedly until you reach the end. At that point the camera will rewind the film as usual.
 - If you take more than the number of shots specified on the roll of film, the last frame or two may be cut off in the developing process.

8. Neckstrap and Case

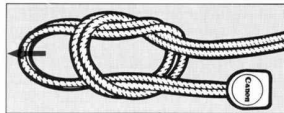

The neckstrap is permanently fixed to the camera. Please adjust the length by knotting it at the end as illustrated.

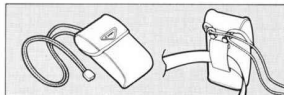

You can carry the camera on your belt. To avoid losing the case slide the neckstrap through the two small loops as shown.



9. Specifications

TYPE: 35mm lens-shutter camera with automatic film advance, automatic film rewind, automatic exposure and fixed focal point.

FORMAT: 24 × 36mm.

LENS: Canon lens. 35mm f/4.5, 3-group, 3-element.

ROTARY LENS COVER: Open position: shooting is possible. Closed position: shooting is impossible.

FOCUSING: Fixed at 3m (10 ft.).

SHOOTING DISTANCE RANGE: 1.5m (5ft.) to infinity.

SHUTTER: Programmed electromagnetic shutter; also serves as diaphragm blades.

VIEWFINDER: Reverse Galilean type, magnification: 0.45X. Field surrounded by yellow frame. Battery check/Use flash lamp (red LED).

FILM LOADING: Automatic film loading by aligning leader with positioning mark.

FILM WINDING: Automatic.

FILM REWINDING: Rewind starts automatically at end of film, stops automatically when rewind is complete.

BACK COVER: Opened by pressing back cover latch.

FRAME COUNTER: Additive type; automatically resets to "S" by opening back cover. Counts back with film rewind. Also serves to confirm correct film loading.

FILM SPEED: DX code sensor automatically sets film speed to ISO 100 or 400.

AUTOMATIC EXPOSURE COUPLING RANGE:

EV10 - 15 (ISO 100).

BUILT-IN FLASH: Horizontal sliding type, turned on by sliding flash out.

GUIDE NUMBER: 9 (ISO 100 - meters).

AUTO FLASH SHOOTING DISTANCE RANGE:

1.5 - 3.2m (5 - 10.5 ft.) with ISO 100 negative film,

1.5 - 6.4m (5 - 21 ft.) with ISO 400 negative film.

FLASH RECYCLING TIME: 8 sec. or less (interval between firing of flash and relighting of flash-ready lamp) with new alkaline batteries.

BATTERY LIFE: With new alkaline batteries at normal temperatures: without flash, approximately 50 rolls of 24-exp. film. Using flash for each exposure, approximately 5 rolls of 24-exp. film.

POWER SOURCE: Two size-AAA alkaline batteries (LR03, 3V). Ni-Cd batteries cannot be used.

DIMENSIONS: 123(W) × 68.7(H) × 44.2(D) mm (4-13/16" × 2-11/16" × 1-3/4")

WEIGHT: 240g (8-1/2 ozs.) including batteries.

