



**Canon**

**Canon**

***PowerShot*  $\epsilon$ 1**  
DIGITAL CAMERA

Camera User Guide

ENGLISH

FOR PERSONAL USE ONLY  
[thecanoncollector.com](http://thecanoncollector.com)

## Checking the Package Contents

Check if the following items are included in your camera package. If anything is missing, contact the retailer where you purchased the camera.



Camera



AA-size Alkaline  
Batteries (x2)



Memory Card  
(32MB)



Interface Cable  
IFC-400PCU



AV Cable  
AVC-DC400



Wrist Strap  
WS-DC6



Canon Digital Camera  
Solution Disk



Warranty Card



"Canon Customer  
Support" Leaflet



### Getting Started



Also refer to the electronic manuals (PDF) on the CD-ROM.

#### •Camera User Guide

This Guide

#### •Direct Print User Guide

Read when you want to connect the camera to a printer and print.

#### •Software Starter Guide

Read when you want to connect the camera to a computer.

Explains how to install and use the software on the Canon Digital Camera Solution Disk.

Download ZoomBrowser EX/ImageBrowser Software Guide (PDF) from:

<http://web.canon.jp/imaging/information-e.htm>



- You can use the included memory card to try out your new camera and take some test shots.
- Adobe Reader must be installed to view the PDF manuals.

## Conventions Used in this Guide

- Language that displays on the screen appears inside [ ].
- Buttons on the camera body are represented by the following icons.

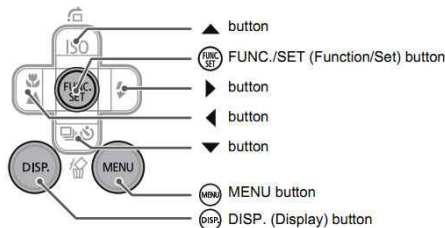

- : Troubleshooting tips for common problems.
- : Hints for getting more out of your camera.
- : Notes for preventing malfunction.
- : Supplemental explanation.
- (p. xx): xx stands for reference page number.
- This guide assumes all functions are at their default settings unless otherwise noted.
- This camera can use various types of memory cards. These are collectively referred to as memory cards in this guide.

## Read This First

### Test Shots

Take some initial test shots and play them back to make sure the images were recorded correctly. Please note that Canon Inc., its subsidiaries and affiliates, and its distributors are not liable for any consequential damages arising from any malfunction of a camera or accessory, including memory cards, that results in the failure of an image to be recorded or to be recorded in a way that is machine readable.

### Warning Against Copyright Infringement

Please note that Canon digital cameras are intended for personal use and should never be used in a manner that infringes upon or contravenes international or domestic copyright laws and regulations. Please be advised that in certain cases the copying of images from performances, exhibitions, or commercial properties by means of a camera or other device may contravene copyright or other legal rights even if the image was shot for personal use.

### Warranty Limitations

This camera's warranty is only effective in the country of sale. If there is a problem with the camera while abroad, please return it back to the country of sale before proceeding with a warranty claim to a Canon Customer Support Help Desk.

**For Canon Customer Support contacts, please see the customer support list supplied with your camera.**

### LCD Monitor

The LCD monitor is produced with extremely high-precision manufacturing techniques. More than 99.99% of the pixels operate to specification, but occasionally non-performing pixels may appear as bright or dark dots. The camera is not damaged. This also has no effect on the recorded image.

### Camera Body Temperature

Please take care when operating the camera for an extended period as the camera body may become warm. The camera is not damaged.



## Capture Your Best Memories



## Shoot

- Shoot, Leaving It to the Camera to Make Settings . . . . . 22
- Just Taking Pictures (Easy mode) . . . . . 54
- Shooting Various Scenes . . . . . 55–58

- Take good shots of people



- Take good landscapes



- Shoot various other scenes



- Focus on faces . . . . . 80
- Shoot in places where I cannot use the flash (turn off the flash) . . . . . 59
- Shoot pictures with me in them too (self-timer) . . . . . 60
- Insert the date and time into my pictures . . . . . 63
- Take close-up pictures of subjects (macro shooting) . . . . . 64
- Take sepia toned or black and white pictures . . . . . 75
- Change the size of picture I want to take (recording pixels) . . . . . 70
- Take pictures continuously . . . . . 69
- Shoot without camera shake (image stabilization) . . . . . 124
- Shoot without camera shake even in low light conditions (high ISO speed) . . . . . 58, 72

## View

- Look at my pictures . . . . . 24
- Automatically play back pictures (slide show) . . . . . 98
- Look at pictures on a TV . . . . . 100
- Quickly search pictures . . . . . 94
- Erase pictures . . . . . 25, 101
- Protect pictures from accidental erasure . . . . . 102

## Shoot/View Movies

- Shoot movies . . . . . 28
- Watch my movies . . . . . 30

## Print

- Easily print my pictures . . . . . 26

## Save

- Save images to a computer . . . . . 31, 108, 109

## Other

- Turn off sound . . . . . 51



# Table of Contents

Chapters 1 – 3 explain the basic operations and frequently used functions of this camera. Chapters 4 – 9 explain the advanced functions letting you learn further as you read them in order.

Checking the Package Contents .....	2	Formatting Memory Cards .....	49
Conventions Used in this Guide .....	3	Changing Sounds .....	51
Read This First .....	4	Changing the Image Display Time ..	52
What Do You Want to Do? .....	6		
Safety Precautions .....	10		
LCD Monitor Precautions .....	12		

## 1 Getting Started ..... 13

Inserting the Batteries and Memory Card .....	14
Setting the Date and Time .....	18
Setting the Display Language .....	20
Pressing the Shutter Button .....	21
Taking Pictures .....	22
Viewing Images .....	24
Erasing Images .....	25
Printing Images .....	26
Shooting Movies .....	28
Viewing Movies .....	30
Transferring Images to a Computer ..	31
Accessories .....	36
Separately Sold Accessories .....	38

## 2 Learning More..... 39

Components Guide .....	40
Indicators .....	42
Power Saving Function (Auto Power Down) .....	42
Information Displayed on the Screen ..	43
Switching the Display .....	45
FUNC. Menu - Basic Operations .....	46
MENU Functions - Basic Operations ..	47
Resetting the Camera .....	48

## 3 Shooting Special Scenes and Using Common Functions ..... 53

Just Taking Pictures (Easy Mode) .....	54
Shooting Various Scenes .....	55
Shooting Special Scenes .....	56
Turning the Flash Off .....	59
Turning the Flash On .....	59
Using the Self-Timer .....	60
Zooming in on Far Away Subjects ..	61
Inserting the Date and Time .....	63
Shooting Close-ups (Macro) .....	64
Shooting Far Away Subjects .....	65

## 4 Making Settings for the Images You Want..... 67

Shooting in Program AE .....	68
Continuous Shooting .....	69
Changing the Recording Pixels (Image Size) .....	70
Changing the Image Quality (Compression Ratio) .....	70
Changing the ISO Speed .....	72
Adjusting the Tone (White Balance) ..	73
Adjusting the Brightness (Exposure Compensation) .....	74
Changing the Tone of an Image (My Colors) .....	75

Changing the Composition to Shoot (Focus Lock) .....	76
Shooting Using the Viewfinder .....	77
Shooting Using a TV .....	77
Customizing the Self-Timer .....	78

## 5 Getting More Out of Your Camera..... 79

Changing the AF Frame .....	80
Checking the Focus and People's Expressions (AF-Point Zoom) .....	82
Selecting the Face to Focus On (Face Select and Track) .....	83
Checking the Focus Immediately after Shooting (Focus Check) .....	84
Changing the Metering Mode .....	85
AF Lock Shooting with AF Lock .....	85
AE Lock Shooting with AE Lock .....	86
FE Lock Shooting with FE Lock .....	87
Slowing Down the Shutter Speed (Long Shutter Mode) .....	88

## 6 Using Various Functions for Movies..... 89

Changing the Movie Mode .....	90
Changing the Image Quality in  ..	90
Shooting Movies With Fixed Exposure Settings .....	91
Other Shooting Functions .....	92
Playback Functions .....	92

## 7 Using Various Playback and Other Functions..... 93

Quickly Finding Images .....	94
Organizing Images by Category (My Category) .....	96
Magnifying Images .....	97
Viewing Slideshows .....	98

Checking the Focus and People's Expressions (Focus Check Display) .....	99
Viewing Images on a TV .....	100
Changing Image Transitions .....	101
Erasing All Images .....	101
Protecting Images .....	102
Resizing Images .....	103
Rotating Images .....	104
Correcting Red-Eye Effect .....	105
Attaching Sound Memos .....	107
Transferring Images to a Computer ..	108
Designating Images for Transfer (DPOF) .....	109
Designating Images for Printing (DPOF) .....	111

## 8 Customizing the Camera ..... 117

Changing Functions .....	118
Changing Shooting Functions .....	121

## 9 Useful Information for Using the Camera ..... 125

Using Household Power .....	126
Using a Supplementary Flash .....	126
Handling Precautions .....	127
You Think There is a Problem .....	128
Error Messages .....	132
Functions Available in Each Shooting Mode .....	134
Menus .....	136
Specifications .....	140
Index .....	142

- Before using the camera, please ensure that you read the safety precautions described below. Always ensure that the camera is operated correctly.
- The safety precautions noted on the following pages are intended to prevent injuries to yourself and other persons, or damage to the equipment.
- Be sure to also check the guides included with any separately sold accessories you use.



**Warnings** Denotes the possibility of serious injury or death.



**Cautions** Denotes the possibility of injury or damage to the equipment.

### Warnings

## Equipment

- **Do not look through the camera viewfinder at bright light sources (the sun, etc.).**  
Exposure to the intense light may damage eyesight.
- **Store this equipment out of the reach of children and infants.**  
Strap: Putting the strap around a child's neck could result in asphyxiation.  
Memory card, day/date battery: Dangerous if accidentally swallowed. If this occurs, contact a doctor immediately.
- **Do not trigger the flash in close proximity to human eyes.**  
Exposure to the intense light produced by the flash may damage eyesight. In particular, remain at least one meter (39 inches) away from infants when using the flash.
- **Do not attempt to disassemble or alter any part of the equipment that is not expressly described in this guide.**
- **To avoid the risk of injury, do not touch the interior of the camera if it has been dropped or otherwise damaged.**
- **Stop operating the camera immediately if it emits smoke, a strange smell, or otherwise behaves abnormally.**
- **Do not allow liquids or foreign objects to enter the camera.**  
This could result in fire or electrical shock.  
If liquid or foreign objects come into contact with the camera interior, immediately turn the camera power off and remove the batteries.
- **Do not use organic solvents such as alcohol, benzene, or thinner to clean the equipment.**
- **Use only recommended power sources.**

## Batteries

- **Use only recommended batteries.**
- **Do not place batteries near or in direct flame.**
- **Do not let batteries come into contact with water (e.g. sea water) or other liquids.**
- **Do not attempt to disassemble, alter or apply heat to batteries.**
- **Avoid dropping or subjecting batteries to severe impacts.**  
This may cause explosions or leaks, resulting in fire, injury and damage to the surroundings. In the event that a battery leaks and the eyes, mouth, skin or clothing contacts these substances, immediately flush with water and seek medical assistance.
- **Before you discard batteries, cover the terminals with tape or other insulators.**  
Contacting other metal materials in waste containers may lead to fire or explosions.

### Cautions

- **Do not aim the camera at bright light sources (the sun, etc.).**  
Doing so may cause malfunction or damage the image sensor (CCD).
- **Be careful not to bang the camera or subject it to strong impacts or shocks when hanging it by the strap.**
- **Be careful not to bump or push strongly on the lens.**  
This could lead to injury or damage the camera.
- **When using the camera on a beach or at a windy location, be careful not to allow dust or sand to enter the camera.**  
This may cause the camera to malfunction.
- **Avoid using, placing or storing the camera in the following places.**
  - Places subject to strong sunlight.
  - Places subject to temperatures above 40° C (104° F).
  - Humid or dusty areas.These could cause leakage, overheating or explosion, resulting in fire, burns or other injuries. High temperatures may also cause deformation of the casing.
- **Remove and store the batteries when you are not using the camera.**  
If the batteries are left inside the camera, damage caused by leakage may occur.
- **Do not use the flash with dirt, dust or other items stuck to the surface, or when covering the flash with your fingers or clothing.**  
This may cause the camera to malfunction.

## LCD Monitor Precautions

- **Do not sit in a chair with the camera in your pocket.**  
Doing so may cause malfunction or damage the LCD monitor.
- **When putting the camera in your bag, ensure that hard objects do not come into contact with the LCD monitor.**  
If this occurs, it may cause malfunction or damage the LCD monitor.
- **Do not attach accessories to the strap.**  
Doing so may cause malfunction or damage the LCD monitor.

## Getting Started

This chapter explains how to prepare for shooting and shooting in **AUTO** mode, as well as how to play back, erase and print images.

### Attaching the Wrist Strap/Holding the Camera

- Use the included strap to avoid dropping the camera during use.
- Keep your arms tight against your body while holding the camera firmly by the sides. Be sure that your fingers do not touch the flash.

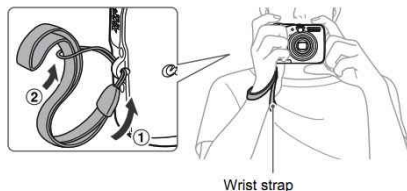

Wrist strap

## Inserting the Batteries and Memory Card

Insert the included batteries and memory card into the camera.

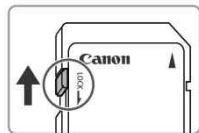

### 1 Check the card's write-protect tab.

- If the memory card has a write-protect tab, you will not be able to take images if the tab is in the locked position. Slide the tab up until you hear a click.

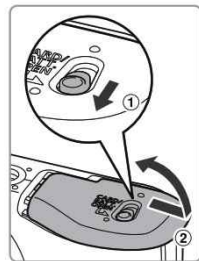

### 2 Open the cover.

- Slide and hold the cover lock (1), then slide and open the cover (2) as shown.

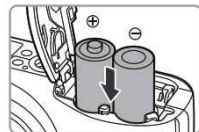

### 3 Insert the batteries.

- Insert the batteries with (+) and (-) sides oriented correctly.



Label

### 4 Insert the memory card.

- Insert the memory card with the label in the direction shown until it clicks into place.
- Be sure the card is oriented correctly. Inserting the card in the wrong direction could damage the camera.

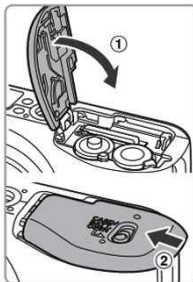

### 5 Close the cover.

- Close the cover (1) and press downward as you slide it until it clicks into place (2).

## Removing the Memory Card

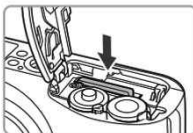

- Push the memory card until you hear a click, then release and pull out the card.



## Approximate Number of Shots That Can Be Taken

Power Source		Alkaline Batteries (Supplied)	NiMH Batteries (Sold Separately)
Number of Shots	LCD monitor on*	220	450
	LCD monitor off	650	1000
Playback Time (Hours)		8	10

\* The number of shots that can be taken is based on the Camera & Imaging Products Association (CIPA) measurement standard.

- Depending on the shooting conditions, the actual number of shots that can be taken may be less.
- Depending on the brand of alkaline batteries used, the number of shots that can be taken may vary widely.
- The values for NiMH batteries are based on fully charged batteries.

## Compatible Batteries

AA-size alkaline batteries and Canon AA-size NiMH batteries (sold separately) (p. 36).

### ? Can any other batteries be used?

We cannot recommend the use of any other batteries than those listed above because performance varies widely.

### 💡 Why use NiMH batteries?

They last much longer than alkaline batteries, especially in cold weather.

## Battery Charge Indicator

When battery charge is low, an icon or message will appear on the screen. If the batteries are charged, the icon or message will not display.

Display	Summary
	Battery charge is low. Prepare new batteries to continue using the camera.
"Change the batteries."	The batteries are depleted. Insert new batteries.

## Approximate Number of Shots That Can Be Saved in a Memory Card

Memory Card	32 MB (supplied)	2 GB	8 GB
Number of Shots	11	749	2994

- Values are based on a camera at default settings.
- The number of shots that can be saved will vary depending on camera settings, the subject and the memory card used.

### ? How do you check the number of shots that can be saved?

The number of shots that can be saved appear on the screen when the camera is in Shooting Mode (p. 22).



Number of shots that can be saved

## Compatible Memory Cards

- SD memory cards
- SDHC memory cards
- MultiMediaCards
- MMCplus memory cards
- HC MMCplus memory cards



### ? What is the Write-Protect Tab?

SD and SDHC memory cards have a write-protect tab. If this tab is in the locked position, "Card Locked!" will appear on the screen and you will not be able to take or erase images.

## Setting the Date and Time

The Date/Time menu will appear the first time the camera is turned on. Since the date and time recorded into your images are based on these settings, be sure to make them.

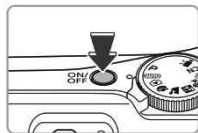

### 1 Turn on the camera.

- Press the power button.
- ▶ The Date/Time menu will appear.



### 2 Set the Date and Time.

- Press the ◀▶ buttons to select a setting.
- Press the ▲▼ buttons to set a value.

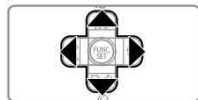

### 3 Make the setting.

- Press the button.
- ▶ Once the date and time have been set, the Date/Time menu will close.

## Changing the Date and Time

You can change the date and time as needed.



### 1 Display the menus.

- Press the button.

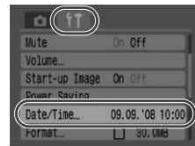

### 2 Select [Date/Time] in the ↑↑ tab.

- Press the ◀▶ buttons to select the ↑↑ tab.
- Press the ▲▼ buttons to select [Date/Time], then press the button.



### 3 Change the date and time.

- Follow Steps 2 and 3 on the left page to change the date and time.
- To close the menus, press the button.

## ? Reappearing Date/Time Menu

- Set the correct date and time. If you have not set the date and time, the Date/Time menu will appear each time you turn on the camera.
- If you removed the batteries from the camera, it is possible that the Date/Time settings are deleted after approximately 3 weeks. If this occurs, set the date and time again.



This camera is equipped with a built-in rechargeable lithium ion battery to save the Date/Time settings. You can recharge the battery when inserting AA-size alkaline batteries or using the separately sold AC adapter, within approximately 4 hours. You do not need to turn the camera on for charging the battery.

## Setting the Display Language

You can change the language displayed on the screen menus and messages.



### 1 Set to Playback mode.

- Press the button.



### 2 Display the language menu.

- Press and hold the button ①, then press the button ②.

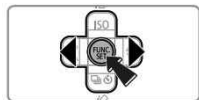

### 3 Set the display language.

- Press the buttons to select a language, then press the button.
- ▶ Once the display language has been set, the language menu will close.



You can also change the language by pressing the button, in the tab, selecting [Language].

## Pressing the Shutter Button

The shutter button has two stops. To take images that are in focus, be sure to first press the shutter button lightly (halfway) to focus, then take the shot.

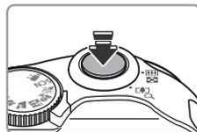

### 1 Press halfway (lightly to the first stop).

- ▶ The camera focuses and automatically makes necessary settings for shooting, such as adjusting brightness and color.
- ▶ When the camera focuses, it will beep twice and the indicator will light green.

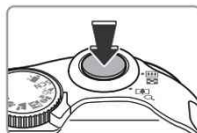

### 2 Press fully (to the second stop).

- ▶ The camera takes the shot.



If you just press the shutter button fully without pausing halfway, the images you take may not be in focus.



## Taking Pictures

The camera can automatically make all settings so that you can shoot simply by pressing the shutter button (Auto mode).



### 1 Turn on the camera.

- Press the power button.
- ▶ The start-up sound will play, and the start-up image will appear.
- Pressing the power button again will turn off the camera.

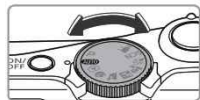

### 2 Select a shooting mode.

- Set the mode dial to **AUTO**.



### 3 Compose the shot of your subject.

- Moving the zoom lever towards **T** will zoom in on your subject making it appear larger. Moving the lever towards **W** will zoom out from your subject making it appear smaller.

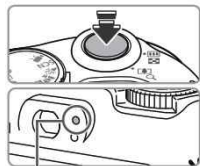

Indicator

### 4 Focus.

- Press the shutter button lightly (halfway) to focus.
- ▶ When the camera focuses, it will beep twice and the indicator will light green (orange when the flash will fire).



AF Frame

- ▶ Green AF frames appear where the subject is in focus.

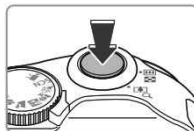

### 5 Shoot.

- Press the shutter button fully.
- ▶ The camera will play the shutter sound and shoot. The flash will automatically fire in low light conditions.
- ▶ The indicator will blink green while the image is recorded to the memory card.
- ▶ The image will appear on the screen for about two seconds. You can continue shooting while the image displays.

### ? What if...

#### ● nothing displays when the camera is turned on?

Press the **DISP** button to turn on the screen (p. 43).

#### ● the camera does not play any sounds?

Pressing the **DISP** button while turning on the camera power will turn off all sounds except for warning sounds. To turn on sound, press the **MENU** button, select the **Y** tab, then select [Mute]. Use the **◀▶** buttons to select [Off].

#### ● the image comes out dark even the flash fired when shooting?

Subject is too far away for the flash to reach. Shoot the image within the effective flash range of approximately 30 cm – 4.0 m (1.0 – 13 ft.) at maximum wide angle (**W** side), and approximately 30 cm – 2.0 m (1.0 – 6.6 ft.) at maximum telephoto (**T** side).

#### ● the indicator blinks yellow and the camera only beeps once when the shutter button is pressed halfway?

Your subject is too close. Move about 50 cm (1.6 ft.) or more away from your subject. Press the shutter button again halfway, making sure the indicator does not blink yellow before taking the picture.

#### ● the screen turns off when you take an image?

When flash recharging begins, the indicator may blink orange and the screen may turn off. When recharging ends, the screen turns on again.

#### ● the lamp lights?

The lamp (Red-Eye Reduction Lamp) lights in order to reduce the red-eye effect that occurs when shooting in dark conditions using the flash. It also emits when assisting the focus (AF-assist Beam).

## Viewing Images

You can view the images you have taken on the screen.



### 1 Set to Playback mode.

- Press the button.
- The last image you took will appear.



### 2 Select an image.

- Pressing the button will cycle through the images in the reverse order they were taken.
- Pressing the button will cycle through the images in the order they were taken.
- The images change more quickly if you keep the buttons pressed, but they will appear coarse.

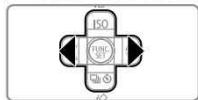

### Recommendation for beginners: Easy mode

Just setting the mode dial to (Easy mode) allows you to shoot and playback images. This mode is recommended for beginners, who are not familiar using cameras.



Easy mode

### 1 Set the mode dial to .

### 2 Shoot.

- Press the shutter button lightly (halfway) to focus.
  - ▶ A green AF frame displays where the subject is in focus.
- Press the shutter button fully to shoot.

### 3 Viewing Images.

- Press the button.
- Press the buttons to display the images you want to view.

## Erasing Images

You can select and erase images one at a time. Please note that erased images cannot be recovered. Exercise adequate caution before erasing an image.



### 1 Set to Playback mode.

- Press the button.
- ▶ The last image you shoot will appear.



### 2 Select an image to erase.

- Press the buttons to select an image to erase.

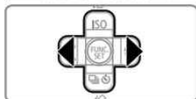

### 3 Erase the image.

- Press the button.
- Press the buttons to select [Erase], then press the button.
- ▶ The displayed image will be erased.
- To exit instead of erasing, press the buttons to select [Cancel], then press the button.



## Printing Images

You can easily print the images you have taken if you connect the camera to a PictBridge compliant printer (sold separately).

### Items to Prepare

- Camera and PictBridge compliant printer (sold separately)
- Interface cable supplied with the camera (p. 2)

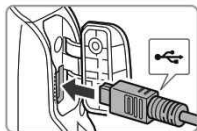

#### 1 Turn off the camera and printer.

#### 2 Connect the camera to the printer.

- Open the camera's terminal cover and insert the smaller plug of the interface cable in the direction shown.
- Insert the cable's larger plug into the printer. For connection details, refer to the user guide provided with the printer.



#### 3 Turn on the printer.



#### 4 Turn on the camera.

- Press the button to turn on the camera.
- ▶ will appear on the screen, and the button will light blue.

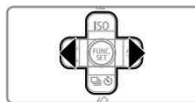

#### 5 Select an image to print.

- Press the buttons to select an image.



#### 6 Print images.

- Press the button.
- ▶ Printing will start and the button will blink blue.
- If you want to print additional images, repeat Steps 5 and 6 after printing has completed.
- After printing has completed, turn off the camera and printer, and unplug the interface cable.



Refer to the *Direct Print User Guide* for details on printing, including printing with direct print compatible printers.

### Canon-Brand PictBridge Compliant Printers (Sold Separately)

By connecting your camera to one of the Canon-brand PictBridge compliant printers below, you can print your images just like photos without having to use a computer.



Compact Photo Printers  
(SELPHY series)





Bubble Jet Printers  
(PIXMA series)

For more information, visit your nearest Canon retailer.

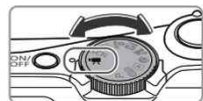
Setting the mode dial to  (Movie) allows you to shoot movies.



## 1 Set to Movie mode.

- Set the mode dial to .
- Confirm that  displays on the screen.



Recordable Time

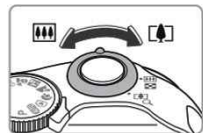

## 2 Compose the shot of your subject.

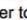
- Moving the zoom lever towards  will zoom in on your subject making it appear larger. Moving the lever towards  will zoom out from your subject making it appear smaller.

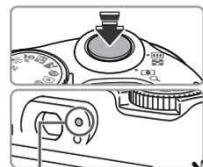

## 3 Focus.

- Press the shutter button lightly (halfway) to focus.
- ▶ When the camera focuses, it will beep twice and the indicator will light green.

Indicator

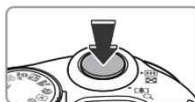

## 4 Shoot.

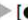
- Press the shutter button fully. The camera will start shooting the movie.
- Once shooting begins, take your finger off the shutter button.
- ▶ [ REC.] and the elapsed time will appear on the screen.
- Do not touch the microphone while shooting.
- Do not press any buttons other than the shutter button. The sound that buttons make will be recorded in the movie.



Elapsed Time



Microphone



## 5 Stop shooting.

- Press the shutter button fully again.
- ▶ The camera will beep once and stop shooting the movie.
- ▶ The indicator will blink green while the movie is recorded to the memory card.
- ▶ Shooting will automatically stop when the memory card fills.

## Approximate Recording Time

Memory Card	32 MB (supplied)	2 GB	8 GB
Recording Time	15 sec.	16 min. 47 sec.	1 hr. 7 min. 6 sec.

- Recording times are based on a camera at default settings.
- Remaining time can be checked on the screen in Step 1.

## Viewing Movies

You can view the movies you have shot on the screen.



### 1 Set to Playback mode.

- Press the button.
- ▶ The last image or movie you shot will appear.



### 2 Select a movie.

- Press the buttons to select a movie, then press the button.
- appears on movies.
- ▶ The movie control panel will appear.

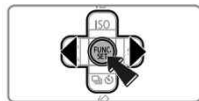

### 3 Play the movie.

- Press the buttons to select , then press the button.
- Pressing the button will pause/resume the movie.
- Press the buttons to adjust the volume.
- ▶ After the movie finishes, appears.



## Transferring Images to a Computer

You can use the included software to transfer the images you have taken to a computer.

### Items to Prepare

- Camera and computer
- Canon Digital Camera Solution Disk supplied with the camera (p. 2)
- Interface cable supplied with the camera (p. 2)

### System Requirements

Install the software on a computer meeting the following requirements.

#### Windows

OS	Windows Vista (including Service Pack 1) Windows XP Service Pack 2	
Computer model	The above OS should be pre-installed on computers with built-in USB ports.	
CPU	Windows Vista:	Pentium 1.3 GHz or higher
	Windows XP:	Pentium 500 MHz or higher
RAM	Windows Vista:	512 MB or more
	Windows XP:	256 MB or more
Interface	USB	
Free Hard Disk Space	● Canon Utilities - ZoomBrowser EX: 200 MB or more - PhotoStitch: 40 MB or more	
Display	1,024 x 768 pixels/High Color (16 bit) or better	

#### Macintosh

OS	Mac OS X (v10.4 – v10.5)	
Computer model	The above OS should be pre-installed on computers with built-in USB ports.	
CPU	PowerPC G4/G5 or Intel Processor	
RAM	Mac OS X v10.5:	512 MB or more
	Mac OS X v10.4:	256 MB or more
Interface	USB	
Free Hard Disk Space	● Canon Utilities - ImageBrowser: 300 MB or more - PhotoStitch: 50 MB or more	
Display	1,024 x 768 pixels/ 32,000 Colors or better	



## Preparations

Windows XP and Mac OS X v10.4 are used for these explanations.

### 1 Install the software.

#### Windows



- ① Place the CD-ROM in the computer's CD-ROM drive.

- ② Begin installation.

- Click [Easy Installation], and follow the onscreen instructions to proceed with the installation.

- ③ Click [Restart] or [Finish].

- When you click [Restart], the computer will restart.

- ④ Remove the CD-ROM.

- Remove the CD-ROM when your desktop screen appears.



#### Macintosh

- Place the CD-ROM in the computer's CD-ROM drive and double-click the .
- ▶ The screen on the left displays.
- Click [Install], and follow the onscreen instructions to proceed with the installation.

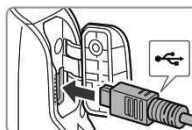

### 2 Connect the camera to the computer.

- Turn off the camera.
- Open the camera's terminal cover and insert the smaller plug of the interface cable in the direction shown.
- Insert the cable's larger plug into the computer's USB port. For connection details, refer to the user guide provided with the computer.

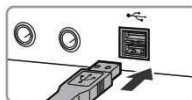

### 3 Turn on the camera.

- Press the  button to turn on the camera.
- ▶ The connection between the camera and computer is now established.

### 4 Open CameraWindow.

#### Windows

- Select [Canon CameraWindow] and click [OK].
- ▶ CameraWindow will appear.
- If CameraWindow does not appear, click the [Start] menu and select [All Programs] or [Programs], followed by [Canon Utilities] ▶ [CameraWindow] ▶ [CameraWindow] ▶ [CameraWindow].
- ▶ The Direct Transfer menu appears on the camera's screen, and the  button will light blue.



## Macintosh



- ▶ CameraWindow will appear.
- If it does not appear, click the [CameraWindow] icon on the Dock (the bar which appears at the bottom of the desktop).
- ▶ The Direct Transfer menu appears on the camera's screen, and the  button will light blue.



You cannot shoot while the Direct Transfer menu displays.

## Transferring Images with a Computer





## Transfer images.

- Click [Transfer Untransferred Images].
- ▶ All images not previously transferred will be transferred to the computer.
- After the transfer finishes, turn off the camera and unplug the cable.
- For further operations, refer to the *Software Starter Guide*.

## Transferring Images with the Camera



## 1 Select [New Images].

- Press the   buttons to select [New Images].
- If the screen on the left is not showing, press the  button.

## 2 Transfer images.

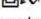
- Press the  button.
- ▶ All images not previously transferred will be transferred to the computer.
- After the transfer finishes, turn off the camera and unplug the cable.
- For further operations, refer to the *Software Starter Guide*.



Transferred images will be sorted by date and saved in separate folders in the My Picture folder for Windows or the Picture folder for Macintosh.



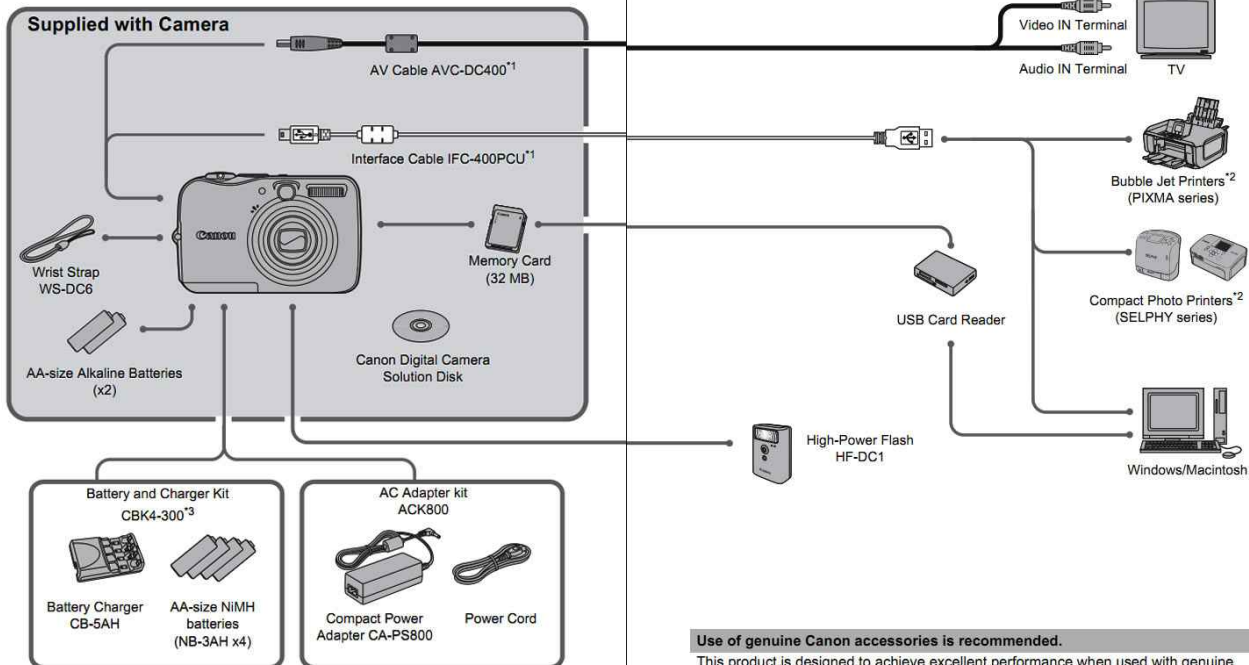

<sup>\*1</sup> Also available for purchase separately.

<sup>\*2</sup> See the user guide supplied with the printer for more information on the printer and interface cables.

<sup>\*3</sup> Battery and Charger Kit CBK4-200 may also be used.

## Use of genuine Canon accessories is recommended.

This product is designed to achieve excellent performance when used with genuine Canon accessories. Canon shall not be liable for any damage to this product and/or accidents such as fire, etc., caused by the malfunction of non-genuine Canon accessories (e.g., a leakage and/or explosion of a battery pack). Please note that this warranty does not apply to repairs arising out of the malfunction of non-genuine Canon accessories, although you may request such repairs on a chargeable basis.

## Separately Sold Accessories

The following camera accessories are sold separately. Some accessories are not sold in some regions, or may no longer be available.

### Power Supplies

- **Battery and Charger Kit CBK4-300**

This kit includes both a dedicated charger unit and four rechargeable AA-size NiMH (nickel metal hydride) batteries. Recommended for powering the camera for an extended period of time.

The batteries (NiMH Battery NB4-300) are also available separately.

- **AC Adapter Kit ACK800**

This kit lets you power the camera using household power. Recommended for powering the camera for an extended period of time or when connecting to a computer. Cannot be used to charge the batteries inside the camera.

### Other Accessories

- **High-Power Flash HF-DC1**

This attachable supplementary flash can illuminate subjects that are too distant for the built-in flash.

When connecting to and using a household power outlet, use only AC Adapter Kit ACK800 (rated input: 100-240 V AC 50/60 Hz, rated output: 3.15 V DC). Using anything else can cause fire, overheating, or electrical shock.

# 2

## Learning More

This chapter explains the camera parts and basic operations.

---

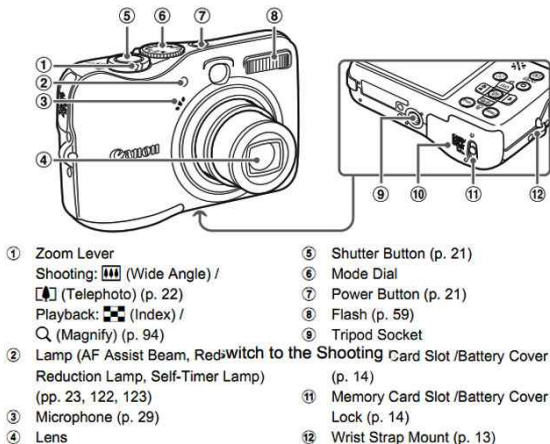

## Mode Dial

Turn the mode dial to change the shooting mode. Turning the mode dial while in Playback mode will switch to the Shooting mode.

### Program AE mode (p. 67)

You can set various functions in order to take the picture you want.

### Auto mode (p. 22)

The camera makes settings automatically for shooting.

### Easy mode (p. 54)

You can shoot worry-free pictures just by pressing the shutter button.

### Movie mode (pp. 28, 89)

### Various Scenes mode (p. 53)

You can shoot with optimal settings for the scene you wish to shoot.

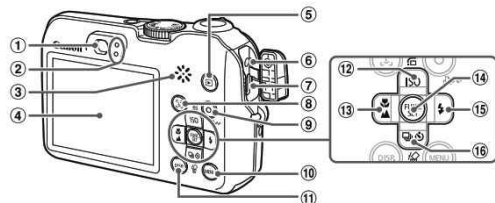

### 1 Viewfinder (p. 77)

### 2 Indicators (p. 42)

### 3 Speaker

### 4 Screen (LCD monitor) (p. 43)

### 5 [P] (Playback) Button

### 6 DC IN (Power input) Terminal

### 7 A/V OUT (Audio/Video output)

### DIGITAL Terminal (pp. 26, 33, 100)

### 8 [F] (Face Select) Button (p. 83)

### 9 [Print/Share] Button

(pp. 26, 124)

### 10 [MENU] Button (p. 47)

### 11 [DISP.] Button (pp. 43, 45)

### 12 ISO (p. 72) / [Jump] (p. 95) /

### ▲ Button

### 13 [Macro] (p. 64) / [Infinity] (p. 65) /

### ◀ Button

### 14 [Function/Set] Button

### 15 [Flash] (p. 59) / [▶] Button

### 16 [Continuous] (p. 69) / [Self-

### timer] (p. 60) / [Single Image Erase]

### (p. 25) / [▼] Button

## [P] Button

When the lens is extended, you can use the [P] button to switch between the Shooting and Playback modes. When the lens is retracted, you can use the button to turn the camera on and off in Playback mode.

### Lens is extended



### Lens is retracted



## Indicators

The indicators on the back of the camera (p. 41) will light or blink under the following conditions.

Position	Colors	Status	Operation Status
Upper Indicator	Green	Lights	Shooting preparation complete (p. 22) /when connected to a computer/display turned off
		Blinks	Camera starting up/image recording/reading/erasing/transferring (when connected to a computer)
	Orange	Lights	Shooting preparation complete (flash on) (p. 22)
		Blinks	Camera shake warning, flash charging (p. 59)
Lower Indicator	Yellow	Lights	Shooting in Macro/AF Lock mode
		Blinks	When the camera cannot focus (p. 23)

**!** When the indicator blinks green, data is being recorded/read/erased or various information is being transmitted.  
Do not turn off the power, open the memory card slot/battery cover, shake or jolt the camera. These actions may corrupt the image data, or cause the camera or memory card to malfunction.

## Power Saving Function (Auto Power Down)

To save battery power, the camera shuts down automatically when it is not operated for a certain time.

### Power Saving Shooting Mode

About 1 minute after the camera is not operated, the screen will turn off. After about 3 more minutes, the lens will retract and the power turns off. When the screen has turned off but the lens has not retracted yet, pressing the shutter button halfway (p. 21) turns on the monitor and shooting can be continued.

### Power Saving Playback mode

About 5 minutes after the camera is not operated, the power turns off.



- You can turn off the Power Saving Function (p. 118).
- You can adjust the time before the screen turns off (p. 119).

## Information Displayed on the Screen

### Shooting (Information Display)

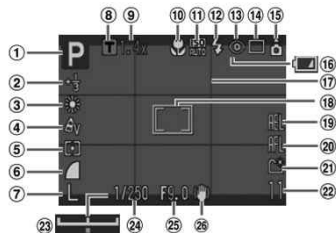

- |  |   |
|--|---|
| ① Shooting Mode  | ⑮ Auto Rotate* (p. 120)                       |
| ② Exposure Compensation/Long Shutter mode (pp. 74, 88) | ⑯ Battery Charge Indicator (p. 16)            |
| ③ White Balance (p. 73)                                | ⑰ Grid Lines (p. 123)                         |
| ④ My Colors (p. 75)                                    | ⑱  AF Frame (p. 80)                           |
| ⑤ Metering Mode (p. 85)                                | ⑲  Spot AE Point Frame (p. 85)                |
| ⑥ Compression Ratio (p. 70)                            | ⑳ AE Lock/FE Lock (pp. 86, 87)                |
| ⑦ Recording Pixels (p. 70)                             | ㉑ AF Lock (p. 76)                             |
| ⑧ Digital Tele-Converter (p. 62)                       | ㉒ Create Folder (p. 120)                      |
| ⑨ Zoom Factor (p. 61)                                  | ㉓ Still Images: Recordable Shots (p. 17)      |
| ⑩ Macro/Infinity Mode (pp. 64, 65)                     | ㉔ Movies: Remaining Time/Elapsed Time (p. 29) |
| ⑪ ISO Speed (p. 72)                                    | ㉕ Exposure Shift Bar (p. 91)                  |
| ⑫ Flash (p. 59)  | ㉖ Shutter Speed                               |
| ⑬ Red-Eye Correction (p. 122)                          | ㉗ Aperture Value                              |
| ⑭ Drive Mode (pp. 60, 69, 78)                          | ㉘ Image Stabilizer (p. 124)                   |

\* :Standard, :Right side down, :Left side down  
This function may not operate correctly when the camera is pointed straight up or down.

## Playback (Detailed Information Display)

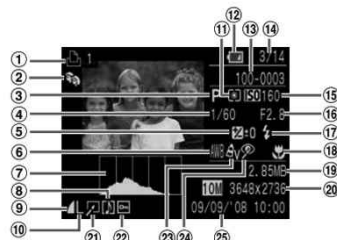

- |   |  |
|---|--|
| ① Print List (p. 111)                               | ⑮ ISO Speed (p. 72)                      |
| ② Auto Category/My Category (p. 96)                 | ⑯ Aperture Value                         |
| ③ Shooting Mode                                     | ⑰ Flash (p. 59)                          |
| ④ Shutter Speed                                     | ⑱ Macro/Infinity Mode (pp. 64, 65)       |
| ⑤ Exposure Compensation (p. 74)                     | ⑲ File Size (p. 71)                      |
| ⑥ White Balance (p. 73)                             | ⑳ Still Images: Recording Pixels (p. 71) |
| ⑦ Histogram   | ㉑ Movies: Movie Length (p. 91)           |
| ⑧ Sound Memo (p. 107)                               | ㉒ Red-Eye Correction /Resize             |
| ⑨ Compression Ratio (p. 70)                         | (pp. 102, 105)                           |
| ⑩ Recording Pixels (p. 70)                          | ㉓ Protect (p. 102)                       |
| ⑪ Metering Mode (p. 85)                             | ㉔ My Colors (p. 75)                      |
| ⑫ Battery Charge Indicator (p. 16)                  | ㉕ Red-Eye Correction (pp. 105, 122)      |
| ⑬ Folder Number-File Number (p. 119)                | ㉖ Shooting Date and Time (p. 18)         |
| ⑭ Displayed image number and total number of images |  |

### Histogram

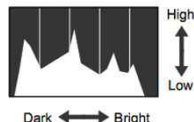

- The graph that appears in Detailed Information Display is called the histogram. The histogram shows the distribution of brightness of an image. When the graph approaches the right side, the image is bright, but when it approaches the left side, the image is dark, and in this way you can check the exposure.

## Switching the Display

You can switch the display using the button.

### Shooting



### Playback

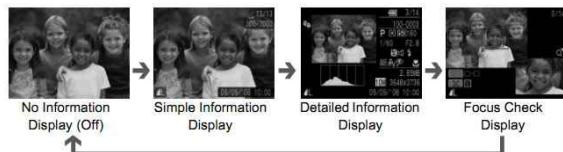

You can also switch the display by pressing the button while the image displays shortly after shooting. However, the Simple Information will not display. You can set the display that displays first. Press the button to select the tab. Then choose [Review Info].

### Display for Shooting in Dark Conditions during Shooting

The display automatically brightens when shooting in dark conditions, allowing you to check the composition (Night Display function). However, the brightness of the image on the screen, and the brightness of the actual image recorded may be different. Noise may appear and the movement of the subject on the screen may appear somewhat jagged. This has no effect on the recorded image.

### Overexposure Warning during Playback

In Detailed Information Display, overexposed areas of the image flash on the screen.



## FUNC. Menu - Basic Operations

You can set various functions using the FUNC. menu. The settings that you can choose from the FUNC. menu are different depending on the shooting mode (p. 40).



### 1 Select a shooting mode.

- Set the mode dial to the desired shooting mode.

### 2 Display the FUNC. menu.

- Press the FUNC. SET button.

### 3 Select a menu item.

- Press the ▲▼ buttons to select a menu item.
- ▶ The selectable settings for the menu item appear at the lower part of the screen.

### 4 Select a setting.

- Press the ◀▶ buttons to select a setting.
- Some option settings are only available by pressing the DISP button after selecting a setting.

### 5 Make the setting.

- Press the FUNC. SET button.
- ▶ Returns you to the shooting screen and the setting you made will display.



Menu Items



For more information on the various shooting modes and combination settings with the FUNC. menu, refer to page 134.

## MENU Functions - Basic Operations

Various functions can be set from the menu. The menu items are organized under categorized tabs, and the displayed tabs and menu items change, depending on the Shooting (p. 40) or Playback mode (p. 41).

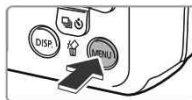

### 1 Display the menu.

- Press the MENU button.

### 2 Select a tab.

- Press the ◀▶ buttons to select a tab.
- You can also move the zoom lever (p. 40) left or right to select a tab.

### 3 Select a menu item.

- Press the ▲▼ buttons to select a menu item.
- Some settings can only be set after switching the screen using the FUNC. SET button.

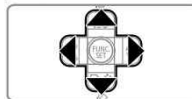

### 4 Select a setting.

- Press the ◀▶ buttons to select a setting.

### 5 Make the settings.

- Press the MENU button.
- ▶ Returns you to the standard screen.

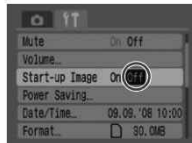

For more information on the tabs and menu items, refer to page 136.

## Resetting the Camera

When you have mistakenly made a setting, you can reset the camera to the default settings.

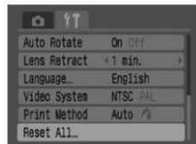

### 1 Display the menu.

- Press the button.

### 2 Select [Reset All].

- Press the buttons to select the tab.
- Press the buttons to select [Reset All], then press the button.



### 3 Reset settings.

- Press the buttons to select [OK], then press the button.
- ▶ The camera will reset to the default settings.

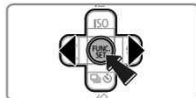

## ? Are there functions that cannot be reset?

- **FUNC. menu**  
White balance data recorded with the Custom White Balance function (p. 73).
- **The tab**  
[Date/Time] (p. 18), [Language] (p. 20), [Video System] (p. 100)

## Formatting Memory Cards

You should use this camera to format a new memory card, or a memory card that has been used with other devices, before using it. Formatting a memory card erases all data on the memory card. You cannot retrieve the erased data. Execute adequate caution before formatting a memory card.

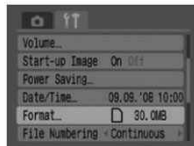

### 1 Display the menu.

- Press the button.

### 2 Select [Format].

- Press the buttons to select the tab.
- Press the buttons to select [Format], then press the button.

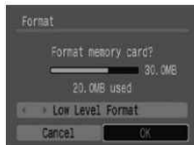

### 3 Format the memory card.

- Press the buttons to select [OK], then press the button.
- ▶ The memory card will be formatted.
- ▶ When formatting has finished, the screen will return to the menu display.





## Low Level Format

Perform low level formatting when you think that the recording/reading speed of a memory card has dropped.



- Follow Step 1–2 on the previous page to display the [Format] screen.
- Press the  $\blacktriangle$   $\blacktriangledown$  buttons to select [Low Level Format], then use the  $\blacktriangleleft$   $\blacktriangleright$  buttons to display  $\checkmark$ .
- Press the  $\blacktriangleleft$   $\blacktriangleright$  buttons to select [OK], then press the  $\text{FUNC}$  button.
- ▶ Low level formatting starts.

## ? About Formatting

- The supplied memory card has already been formatted.
- When the "Memory card error" message appears, or when the camera does not work correctly, formatting the memory card may solve the problem. Copy the images from the memory card to a computer or other device before formatting.



Formatting or erasing data on a memory card merely changes the file management information on the card and does not ensure its contents are completely deleted. Be careful when transferring or disposing of a memory card. When disposing of a memory card, take precautions such as physically destroying the card to prevent personal information leaks.



- The total capacity of the memory card displayed in the [Format] screen may be less than indicated on the memory card.
- Low level formatting may take longer than standard formatting, since all recorded data are erased.
- You can stop a low level format of a memory card by selecting [Stop]. When stopping low level formatting, the data will be erased but the memory card can be used without problem.

## Changing Sounds

You can silence the sounds of the camera buttons or adjust the volume of the camera sounds.

### Mute Setting

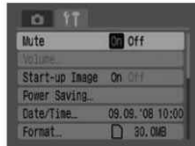

#### 1 Display the menu.

- Press the  $\text{MENU}$  button.

#### 2 Select [Mute].

- Press the  $\blacktriangleleft$   $\blacktriangleright$  buttons to select the  $\uparrow\uparrow$  tab.
- Press the  $\blacktriangle$   $\blacktriangledown$  buttons to select [Mute], then use the  $\blacktriangleleft$   $\blacktriangleright$  buttons to select [On].

### Adjusting the Volume

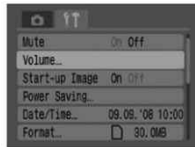

#### 1 Display the menu.

- Press the  $\text{MENU}$  button.

#### 2 Select [Volume].

- Press the  $\blacktriangleleft$   $\blacktriangleright$  buttons to select the  $\uparrow\uparrow$  tab.
- Press the  $\blacktriangle$   $\blacktriangledown$  buttons to select [Volume], then press the  $\text{FUNC}$  button.



### 3 Adjust the volume.

- Press the ▲▼ buttons to select an item, then use the ◀▶ buttons to adjust the volume.

## Changing the Image Display Time

Images display for approximately 2 seconds after being shot. You can change the length of time the images display.

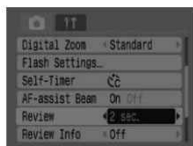

### 1 Display the menu.

- Press the MENU button.

### 2 Select [Review].

- Press the ◀▶ buttons to select the camera icon.
- Press the ▲▼ buttons to select [Review], then press the ◀▶ buttons to select the display time.
- If you select [Off], the image will not display.
- If you select [Hold], the image displays until you press the shutter button halfway.

# 3

## Shooting Special Scenes and Using Common Functions

This chapter explains the for beginners convenient Easy mode and how to shoot various scenes with optimal settings. Other common functions, such as the flash and the self-timer, are also explained.

- This chapter assumes the shooting mode is set to **AUTO**. For other shooting modes refer to the Functions Available in Each Shooting Mode section (p. 134).



## Just Taking Pictures (Easy Mode)

Setting the mode dial to  (Easy mode) allows you to shoot just by pressing the shutter button. The camera automatically sets the optimal settings so that you can shoot worry-free in any shooting condition.



### 1 Select a shooting mode.

- Set the mode dial to .

### 2 Shoot.

#### • Taking worry-free pictures of people

When taking pictures of people, the camera detects the faces and focuses automatically, so that you can capture them just in the right moment.

#### • Shooting worry-free close-ups

Even when shooting close subjects, you do not need to worry about the focus.

#### • Viewing images

Pressing the  button allows you to view the images you took. A guidance will display on the screen so that you can securely check your images.



## What you can do in the Easy mode

In the Easy mode you can use the following operations. Other buttons cannot be used. Therefore, you do not need to worry about wrong operations.

### Taking Pictures (Shooting mode)

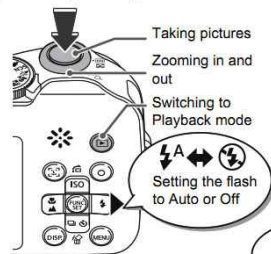

### Viewing Images (Playback mode)

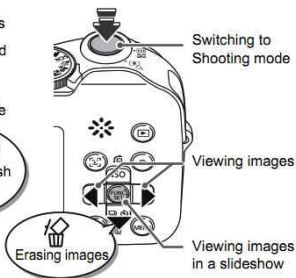

## Shooting Various Scenes

The camera will make the optimal settings for the scene you wish to shoot when you set the mode dial to a matching mode.



### 1 Select a shooting mode.

- Set the mode dial to the scene you wish to shoot.

### 2 Shoot.



#### (Portrait)

#### Take portraits

- Produces a soft effect when photographing people.



#### (Landscape)

#### Take landscapes

- For shooting expansive landscapes.



#### (Night Snapshot)

#### Take snapshots at night

- Lets you take beautifully lit snapshots of people against beautiful city nightscapes or night backgrounds.
- If you hold the camera firmly, you can take pictures with reduced camera shake, even without a tripod.



#### (Kids&Pets)

#### Take shots of kids and pets

- Lets you capture subjects that move around, such as children and pets, without missing photo opportunities.



### (Indoor)

#### Take indoor shots

- Lets you shoot indoors with natural colors.



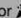
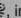





In , , or , images may appear rough because the ISO speed (p. 72) was increased to match the shooting conditions.

## SCN Shooting Special Scenes

The camera will make the optimal settings for the special scene you wish to shoot when you select a matching mode.



### 1 Select a shooting mode.

- Set the mode dial to **SCN**, then press the  button.
- Press the   buttons to select , then use the   buttons to select a shooting mode.
- Press the  button.



### 2 Shoot.



### (Night Scene)

#### Take night scenes

- Lets you take beautifully lit city nightscapes or night backgrounds.



### (Sunset)

#### Shooting Sunsets

- Lets you shoot sunsets in vivid colors.



### (Foliage)

#### Take shots of foliage

- Lets you shoot trees and leaves such as new growth, autumn leaves or blossoms in vivid colors.



### (Snow)

#### Take shots of people and snow

- Lets you take shots of properly lit people against snowy backgrounds with natural colors.



### (Beach)

#### Take shots of people at the beach

- Lets you take shots of properly lit people at the beach where reflected sunlight is strong.



### 🎆 (Fireworks)

#### Take shots of fireworks

- Lets you take shots of fireworks in vivid colors.



### 🐠 (Aquarium)

#### Take shots of aquatic life in an aquarium

- Lets you shoot aquatic life in indoor aquariums with natural colors.



### ISO 3200

#### Shooting with high ISO speed

- Lets you shoot with the ISO speed set to 3200. At high ISO speed the shutter speed is faster and reduces subject blur and camera shake during shooting.
- Recording pixels are set to **M3** (1600 x 1200 pixels).



- In 🎆, images may appear rough if the ISO speed (p. 72) was increased depending on the scene.
- In 🎆 or 🐠, attach the camera to a tripod so that the camera does not move and blur the image. When you attach the camera to a tripod, you are recommended to set [IS Mode] to [Off] to shoot (p. 124).
- In 🎆, make sure the subject does not move until the shutter sound plays, even after the flash fires.
- With ISO 3200, image noise may be prominent.



## Turning the Flash Off

You can turn the flash off for shooting in places where using a flash is prohibited.

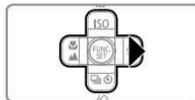

### 1 Press the ► button.



### 2 Select 🚫.

- Press the ◀ ▶ buttons to select 🚫, then press the button.
- ▶ 🚫 will appear on the screen.
- After taking the shot, repeat the above steps to select 🚫.



### What if the indicator blinks orange and a flashing 🚫 appears?

When you press the shutter button halfway in low light conditions where camera shake is likely, the indicator will blink orange and a flashing 🚫 will appear on the screen. Attach the camera to a tripod so that the camera does not move.



## Turning the Flash On

Select any shooting mode other than **AUTO**, and the flash will fire every time you shoot.

- Choose 🚫 as in Step 2 in the above section "Turning the Flash Off".
- The range of the flash for shooting is approximately 30 cm – 4.0 m (1.0 – 13 ft.) at maximum wide angle, and approximately 30 cm – 2.0 m (1.0 – 6.6 ft.) at maximum telephoto.
- After taking the shot, repeat the above steps to select 🚫.



## Using the Self-Timer

Use the self-timer when you want to appear in the shot you are taking.



### 1 Press the button.



### 2 Select a timer.

- Press the buttons to select for a 10 second delay, or for a 2 second delay, before the shot is taken.
- Press the button.
- ▶ The timer you set displays on the screen.

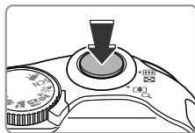

### 3 Shoot.

- Press the shutter button halfway to focus on the subject, then press fully.
- ▶ The lamp blinks and the self-timer sound plays.
- ▶ 2 seconds before the shutter releases, the lamp and sound speed up.
- After the shot is taken, return to Step 2 and select .



You can change the delay time and number of shots to take (p. 78).

## Zooming in on Far Away Subjects

The digital zoom can zoom up to 16x and capture subjects too far away for the optical zoom (p. 22). The images may appear rough, however, depending on the recording pixel setting (p. 70) and the zoom factor used.

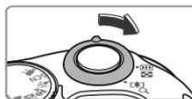

### 1 Move the zoom lever toward .

- Hold the zoom lever until zooming stops.



### 2 Release the zoom lever and then move it toward again.

- ▶ The camera will zoom in further on the subject.

## Image Deterioration Zones with Digital Zoom

Recording Pixels	Optical Zoom	Digital Zoom
<b>L</b>	4.0x→	
<b>M1</b>	4.0x→	
<b>M2</b>		5.6x→
<b>M3</b>		9.1x→
<b>S</b>		16x→

- No image deterioration (zoom factor appears white)
- Image deterioration (zoom factor appears blue)
- Zoom factor at which zooming stops for a moment (safety zoom)



## Turning Off the Digital Zoom

To turn off the digital zoom, press the button, select the tab, and then select the [Digital Zoom] menu item and [Off] option.



The focal length when using digital zoom is 35 – 560 mm (35mm film equivalent).

## Digital Tele-Converter

The focal length of the lens can be increased by an equivalent of 1.4x and 2.3x. This enables a faster shutter speed and less chance of camera shake than just using zoom (including digital zoom) at the same zoom factor.

The images may appear rough, however, depending on the combination of recording pixel (p. 70) and digital tele-converter settings used.

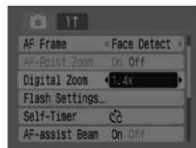

### 1 Select [Digital Zoom].

- Press the button.
- Select the tab, then press the to select [Digital Zoom].

### 2 Accept the setting.

- Press the to select [1.4x] or [2.3x].
- Pressing the button will return you to the shooting screen.
  - ▶ The view will be enlarged, and and the zoom factor will display on the screen.
- After taking the shot, select [Standard] in [Digital Zoom].

## Combinations that Cause Image Deterioration

- Using [1.4x] at a recording pixel setting of **L** or **M1** will cause image deterioration (the zoom factor will display in blue).
- Using [2.3x] at a recording pixel setting of **L**, **M1** or **M2** will cause image deterioration (the zoom factor will display in blue).



- The respective focal lengths when using [1.4x] and [2.3x] are equivalent to 49 – 196 mm and 80.5 – 322 mm (35mm film equivalent).
- The digital tele-converter cannot be used together with the digital zoom.

## Inserting the Date and Time

The date and time an image was shot can be recorded in the lower right corner. Once inserted, however, they cannot be deleted. Be sure to check beforehand that the date and time are correctly set (p. 18).



### 1 Select the recording pixels.

- Press the button.
- Press the to select **L**.

### 2 Select (p. 70).

- Press the to select .
- If you want to insert the date and time, press the button, use the to select [Date & Time], then press the button.



### 3 Shoot.

- The gray areas on the top and bottom of the screen will not be printed. Be sure your subject is within the printable area when you shoot.



## Inserting and Printing the Date and Time in Images Not Shot in

- Use the DPOF print settings (p. 111) to print.
- Use the included software to print.  
Refer to the *Software Starter Guide* for details.
- Connect the camera to a printer to print.  
Refer to the *Direct Print User Guide* for details.



- Images shot in are shot with a small number of recording pixels. Therefore, printing on paper larger than postcard or L size will result in rough photo prints (p. 71).
- The gray areas on the top and bottom of the screen will not be printed; however, the entire image displayed will be recorded.



## Shooting Close-ups (Macro)



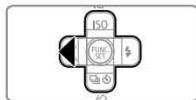

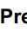
You can shoot an object at a close distance or approach an object to shoot the close-up of it. The focusing range from the end of the lens is 3 – 50 cm (1.2 in. – 1.6 ft.).



1 Press the  button.



2 Select .

- Press the  buttons to select , then press the  button.
- ▶  will appear on the screen.
- After taking the shot, repeat Step 2 and select .

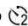

### Using

When shooting with the camera attached to a tripod, set the self-timer to  to avoid camera shake.





The edges of the image may darken if the flash fires.

## Shooting Far Away Subjects

Select any shooting mode other than **AUTO**, then use Infinity mode when the subject is further than approximately 3 m away from the end of the lens.

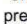

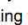
- Select any shooting mode other than **AUTO** and follow Step 2 as described in “Shooting Close-ups (Macro)” on the previous page. Then select .
-  displays on the screen.
- After taking the shot, repeat Step 2 of the previous page and select .

# 4

## Making Settings for the Images You Want

This chapter explains how to use **P** (Program AE) mode and various camera functions.

---

- This chapter assumes the shooting mode is set to **P**. For other shooting modes refer to the Functions Available in Each Shooting Mode section (p. 134).

## P Shooting in Program AE

The camera automatically sets basic functions, but unlike in **AUTO** mode or shooting various scenes, you can freely make your own settings.

\* AE stands for Auto Exposure



- 1 Set the mode dial to **P**.
- 2 Make settings according to purpose. (pp. 69 – 78)
- 3 Shoot.

### ? What if shutter speed and aperture value are displayed in red?

If a correct exposure cannot be obtained when pressing the shutter button halfway, shutter speed and aperture value are shown in red. Try the following settings to obtain the correct exposure.

- Turn on the flash. (p. 59)
- Choose a higher ISO speed. (p. 72)
- Change the metering mode (p. 85)

## Continuous Shooting

You can shoot continuously (about 1.3 shots/second).



- 1 Press the **▼** button.



- 2 Select .
  - Press the **▲▼** buttons to select , then press the **OK** button.
- 3 Shoot.
  - ▶ As long as you hold the shutter button down, the camera will shoot successive images.



### Shooting until the memory card becomes full

If you use a low level formatted (p. 50) memory card, you can continuously shoot until the memory card is full.



- As the number of images increases, the shooting intervals may take longer.
- If the flash fires, shooting intervals may take longer.

## Changing the Recording Pixels (Image Size)

You can choose from 7 types.



### 1 Select the recording pixels.

- Press the button, then use the buttons to select **L**.

### 2 Select a menu item.

- Press the buttons to select a menu item, then press the button.



- If you select or **W**, you cannot use the Digital Zoom (p. 61) or Digital Tele-Converter (p. 62).
- The gray areas in will not be printed; however, the entire image displayed will be recorded.

## Changing the Image Quality (Compression Ratio)

You can choose from 3 types of image quality, in order from high to low: (Superfine), (Fine), (Normal).



### 1 Select the compression ratio.

- Press the button, then use the buttons to select .

### 2 Select a menu item.

- Press the buttons to select a menu item, then press the button.

## Approximate Values for Recording Pixels and Compression Ratio

Recording Pixels	Image Quality	Size (Approx. KB)	Recordable Images/Memory Card		
			32 MB (supplied)	2 GB	8 GB
<b>L</b> (Large) 10 M/3648 x 2736		4332	6	448	1792
		2565	11	749	2994
		1226	23	1536	6140
<b>M1</b> (Medium 1) 6 M/2816 x 2112		2720	10	714	2855
		1620	17	1181	4723
		780	37	2363	9446
<b>M2</b> (Medium 2) 4 M/2272 x 1704		2002	14	960	3837
		1116	26	1707	6822
		556	52	3235	12927
<b>M3</b> (Medium 3) 2 M/1600 x 1200		1002	29	1862	7442
		558	52	3235	12927
		278	99	6146	24562
<b>S</b> (Small) 0.3 M/640 x 480		249	111	6830	27291
		150	171	10245	40937
		84	270	15368	61406
(Date Stamp) 2 M/1600 x 1200		558	52	3235	12927
		3243	8	596	2384
		1920	15	1007	4026
<b>W</b> (Widescreen) 3648 x 2048		918	31	2048	8187

\* The figures in this table are determined by Canon measuring conditions and may vary depending on subject, memory card brand, camera settings or other factors.

## Approximate Values for Paper Size

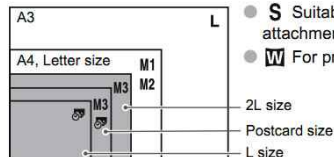

- S** Suitable for sending images as e-mail attachments.
- W** For printing on wide size paper.

## Changing the ISO Speed



1 Press the button.



2 Select a menu item.

- Press the buttons to select a menu item, then press the button.

### Approximate Values for ISO Speed

ISO AUTO	Automatically sets the optimal speed for shooting mode and shooting condition.	
ISO HI	Automatically sets the optimal speed, not only for shooting mode and shooting condition, but also for subject or camera motion. Depending on the scene, the speed may be set higher than in ISO Auto, resulting in less subject blur and camera shake.	
ISO 80 ISO 100 ISO 200	Low	Fine weather condition, outdoor shooting.
ISO 400 ISO 800	↑ ↓	Cloudy, Twilight
ISO 1600		Night view Dark indoor



### Setting the optimal ISO Speed

- Lowering the ISO speed results in crisper images.
- Raising the ISO speed results in a faster shutter speed and thus in reduced camera shake. The flash reaches a greater distance to the subject. However, images will be coarser.



- When the camera is set to or , you can press the shutter button halfway to display the automatically set ISO speed.
- You can raise the ISO speed even higher with the ISO 3200 setting (p. 58).

## Adjusting the Tone (White Balance)

The White Balance (WB) function adjusts the optimal white balance for natural looking colors.



1 Select a white balance setting.

- Press the button, then use the buttons to select **AWB**.

2 Select a menu item.

- Press the buttons to select a menu item, then press the .
- After shooting, return the setting to **AWB**.

AWB	Auto	Automatically sets the optimal white balance for the location.
	Daylight	Fine weather condition, outdoor shooting.
	Cloudy	Cloudy, shady, twilight conditions.
	Tungsten	Tungsten, bulb-type 3-wavelength fluorescent.
	Fluorescent	Warm-white, cool-white, warm-white-type (3-wavelength) fluorescent.
	Fluorescent H	Daylight fluorescent, daylight-type (3-wavelength) fluorescent.
	Custom	Manually sets the custom white balance.



This function cannot be used when My Colors is set to or .

### Custom White Balance

You can adjust the white balance to the light source at the shooting location and shoot with the appropriate color. Make sure that you set the white balance under the light source of the shooting scene.



- Follow the Step 2 described above and select . Make sure the entire screen is filled with the white subject, then press the .
- ▶ The tint on the screen will change when the white balance data is set.
- After shooting, return the setting to **AWB**.



## Adjusting the Brightness (Exposure Compensation)

You can adjust the standard exposure set by the camera in 1/3-stop increments in the range of -2 to +2.



### 1 Select the exposure compensation.

- Press the button, then use the buttons to select  $\pm 0$ .

### 2 Adjust the Brightness.

- While watching the screen, press the buttons to adjust the brightness, then press the button.
- After the picture has been taken, return the setting to (zero).

## Changing the Tone of an Image (My Colors)

You can change the tone of an image such as sepia or black and white when shooting.



### 1 Select a My Colors setting.

- Press the button, then use the buttons to select .

### 2 Select a menu item.

- Press the buttons to select a menu item, then press the button.
- After shooting, return the setting to .

	My Colors Off	—
	Vivid	Emphasizes the contrast and color saturation for a vivid impression.
	Neutral	Tones down the contrast and color saturation for neutral hues.
	Sepia	Sepia tones.
	B/W	Black and white.
	Custom Color	You can adjust image contrast, sharpness and color saturation in 5 gradations.

### Custom Color



- Follow the Step 2 described above and select , then press the button.
- Press the buttons to select an item, then use the buttons to choose a value, then press the button.
- The more to the right, the value gets stronger/deeper, the more to the left, the value gets weaker/lighter.

## Changing the Composition to Shoot (Focus Lock)

While you press the shutter button halfway, focus and exposure are fixed. You can now recompose and shoot. This is called focus lock.



### 1 Focus on a subject.

- Center a subject at the same focal distance in the screen, and press the shutter button halfway.
- Confirm that the AF Frame on the subject is green.



### 2 Recompose.

- Hold the shutter button pressed halfway and recompose the scene.

### 3 Shoot.

- Press the shutter button fully.

## Shooting Using the Viewfinder

If you want to save battery power, you can use the viewfinder for shooting, instead of the screen. Operations for shooting are the same as when using the screen; however, the view in the viewfinder and the image taken may differ.



### 1 Turn off the screen (p. 45).

- Press the  button to turn off the screen.

### 2 Compose the scene and shoot.

- Use the viewfinder to compose the scene and shoot.

## Shooting Using a TV

You can use a TV to display the camera screen.

- Connect the camera to a TV as described in "Viewing Images on a TV" (p. 100), and set the shooting mode to shoot.
- Operations for shooting are the same as when using the camera's screen.



## Customizing the Self-Timer

You can set the time delay (0 – 30 seconds) and the number of shots (1 – 10 shots).



**1** Press the **▼** button.



**2** Select **☺**.

- Press the **▲▼** buttons to select **☺**, then quickly press the **FUNC** button.



**3** Make settings.

- Press the **▲▼** buttons to select an item, then use the **◀▶** buttons to choose a value, then press the **FUNC** button.



### What if the number of shots is set to more than 2 shots?

- Exposure and white balance settings are fixed to the first shot.
- When you set the time delay to more than 2 seconds, the self-timer lamp and sound speed up 2 seconds before the shutter releases.



- If the flash fires, the shooting interval may take longer.
- If you set a high number of shots, the shooting interval may take longer.
- If the memory card becomes full, shooting stops automatically.

# 5

## Getting More Out of Your Camera

This chapter serves as the advanced version of Chapter 4 and explains how to take pictures using various functions.

- This chapter assumes the shooting mode is set to **P**. For other shooting modes refer to the Functions Available in Each Shooting Mode section (p. 134).

## Changing the AF Frame

You can change the AF (Auto Focus) mode to take the shots you want.

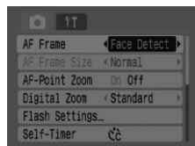

### 1 Select [AF Frame].

- Press the button and select the tab.
- Press the buttons to select [AF Frame].

### 2 Make the setting.

- Press the buttons to select a setting.

## Face Detect

- Recognizes people's faces and focuses, adjusts exposure (evaluative metering only) and white balance (AWB only) for shooting.
- When the camera is pointed at subjects, a white frame appears on the face the camera judges to be the main subject, and gray frames (max. 2) will appear on other faces. When the shutter button is pressed halfway, up to 9 green frames will appear on faces the camera focuses on.



- If a face is not detected and only gray frames (no white frame) appear, the setting will change to [AiAF].
- Examples of faces that cannot be detected:
  - Subjects that are far away or extremely close.
  - Subjects that are dark or light.
  - Faces turned to the side or at a diagonal, or faces with a portion hidden.
- The camera may mistakenly identify non-human subjects as a face.
- Not available when the screen is turned off (p. 45).
- If the camera cannot focus when you press the shutter button halfway, the AF frame will not appear.

## AiAF

The camera automatically selects among 9 AF frames to focus with.



If the camera cannot focus when you press the shutter button halfway, the AF frame will not appear.

## Center

The AF frame will be fixed to the center. This is effective for focusing on a specific point.



### You can reduce the AF frame size

Press the button, select the tab, then select the [AF Frame Size] menu item and the [Small] option.

- The setting is configured to [Normal] when the digital zoom or digital tele-converter is used.



If the camera cannot focus when you press the shutter button halfway, the AF frame will turn yellow.

## Checking the Focus and People's Expressions (AF-Point Zoom)

You can zoom the display of the AF frame to check focus when shooting. When you want to capture people's expressions, set [AF Frame] (p. 80) to [Face Detect]. When you want to check the focus while shooting in Macro mode, set [AF Frame] to [Center].

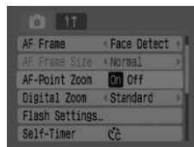

### 1 Select [AF-Point Zoom].

- Press the button and select the tab.
- Press the buttons to select [AF-Point Zoom].

### 2 Accept the setting.

- Press the buttons to select [On], then press the button.

### 3 Check the focus.

- Press the shutter button halfway to check the focus.
- If the AF frame is set to [Face Detect], the face that the camera determined as the main subject is displayed enlarged. If the AF frame is set to [Center], the center of the image is displayed enlarged.

### 4 Shoot.

- Press the shutter button fully.



In the following cases the focus point will not display magnified:

- AF frame is set to [AiAF].
- When [Face Detect] is selected, but no face is detected, or when the face is too large relative to the entire screen.
- When the subject is out of focus.
- When using the digital zoom.
- When the screen is turned off (p. 45).
- When the image is being displayed on a TV screen.

## Selecting the Face to Focus On (Face Select and Track)

You can select a chosen face to focus on and then shoot.



### 1 Set the Face Select mode.

- Point the camera towards the face and press the button.
- ▶ The Face Select mode will activate and a white face frame () will display around the face the camera will focus on. Even if the subject moves, the frame will follow the subject within a certain range.



### 2 Select a face you wish to focus on.

- Press the button, and a face frame will move to the face you wish to focus on. If the frame has moved to all detected faces, the Face Select mode will be canceled.
- Holding down the button will display face frames (up to 35) of all the detected faces (green: the face the camera will focus on, white: detected faces).



### 3 Shoot.

- Press the shutter button halfway. The face frame of the focused face will change into and appears in green.
- Press the shutter button all the way to shoot.



In the following cases, the Face Select mode will be canceled.

- When turning the power off and back on or changing the shooting mode.
- When displaying the Menu screen.
- When using the digital zoom or digital tele-converter.
- When changing the recording pixels to .
- When the screen is turned off (p. 45).
- When the camera cannot detect any face.



## Checking the Focus Immediately after Shooting (Focus Check)

You can check if your subject was in focus, right after shooting. You are recommended to set [Review] in the tab to [Hold] beforehand.

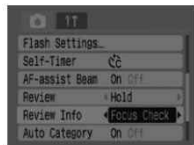

### 1 Select [Review Info].

- Press the button and select the tab.
- Press the to select [Review Info].

### 2 Accept the setting.

- Press the to select [Focus Check], then press the .

### 3 Shoot.

- ▶ The recorded image displays with the AF frame or face frame (white frame around the face), where the subject was focused. At the bottom right displays the content of the orange frame.

### 4 Checking the focus.

- If multiple white frames display, press the or button to switch the display on the bottom right of the screen for checking the focus of each frame.
- You can enlarge the display of the orange frame content by moving the zoom lever towards .
- Pressing the shutter button halfway will return you to the shooting screen.

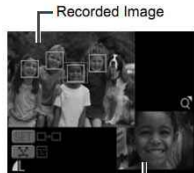

Orange frame contents

You can erase an image while checking the focus (when the screen described in Step 3 displays) by pressing the button.

## Changing the Metering Mode

You can change the brightness metering mode to match the shot you want to take.



### 1 Select the metering mode.

- Press the button, then use the to select .

### 2 Select a menu item.

- Press the to select a menu item, then press the .

Evaluative	Suitable for standard shooting conditions, including back lit shots. Automatically adjusts the exposure so that the subject is always properly lit for the shooting conditions.
Center Weighted Avg.	Averages the light metered from the entire frame, but gives greater weight to the center.
Spot	Only meters within the  (Spot AE Point frame) that appears at the center of the screen.

## AFL Shooting with AF Lock

You can lock focusing. Once the focus is locked, it remains locked even if you let go of the shutter button.

### 1 Focus.

- Point the camera so that the subject of the same shooting distance as the subject you want to take a picture of, is in the AF frame

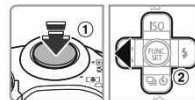

### 2 Lock the focus.

- Keep the shutter button pressed halfway and press the .
- ▶ The focus is locked and AFL displays on the screen.

### 3 Compose the scene and shoot.

- After shooting, press to cancel AF lock.

## AEL Shooting with AE Lock

You can lock the exposure setting and shoot. The focus and exposure can be set separately.

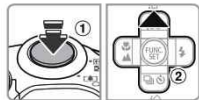

### 1 Lock the Exposure.

- Point the camera at the subject on which you wish to lock the exposure. While pressing the shutter button halfway ①, press the **AE-L/AF-ON** button ②.
- ▶ AEL displays and the exposure is locked.

### 2 Compose the scene and shoot.

- After shooting, press the **AE-L/AF-ON** button to cancel AE lock.

## FEL Shooting with FE Lock

Just like with AE lock (p. 85), you can lock the exposure for shooting with the flash.



### 1 Select **Flash** (p. 59).

### 2 Lock the Flash Exposure.

- Point the camera at the subject on which you wish to lock the exposure. While pressing the shutter button halfway ①, press the **AE-L/AF-ON** button ②.
- ▶ The flash fires and FEL displays. The flash output is retained.

### 3 Compose the scene and shoot.

- After shooting, press the **AE-L/AF-ON** button to cancel FE lock.

## Slowing Down the Shutter Speed (Long Shutter Mode)

You can set the shutter speed to a slow setting to make dark subjects appear brighter. In order to avoid camera shake, attach the camera to a tripod.



### 1 Select the Long Shutter mode.

- Press the button, then use the buttons to select  $\pm 0$ . Press the button.



### 2 Change the shutter speed.

- Use the buttons to change the shutter speed, then press the button.
- The higher the value, the slower the shutter speed and the brighter the recorded image becomes.



When you attach the camera to a tripod, you are recommended to set [IS Mode] to [Off] to shoot (p. 124)

# 6

## Using Various Functions for Movies

This chapter explains how to shoot and view movies, using various functions.

- Set the mode dial to before operating the camera.

## Changing the Movie Mode



### 1 Select a shooting mode.

- Press the button, then use the buttons to select .

### 2 Select a menu item.

- Press the buttons to select a menu item, then press the .

	Standard	This is the Standard mode. You can use the digital zoom during shooting (p. 61).
	Compact	Shooting with reduced recording pixels. You cannot use the zoom during shooting.

## Changing the Image Quality in



### 1 Select the image quality.

- Press the button, then use the buttons to select .

### 2 Select a menu item.

- Press the buttons to select a menu item, then press the .
- ▶ The settings you made will be displayed on the screen.

### Modes and Image Quality Table

Mode	Recording Pixels/Frame Rate	Content
	640 x 480 pixels, 30 frames/sec.	For shooting standard quality movies.
	640 x 480 pixels, 30 frames/sec. LP	The image quality will be lower than with , but you can record twice the length.
	320 x 240 pixels, 30 frames/sec.	Since the number of the recording pixels is smaller, the image quality will be lower than with , but you can record three times the length.
	160 x 120 pixels, 15 frames/sec.	Suitable for attaching to e-mails, due to the small file size.

## Estimated Shooting Time

Mode	Image Quality (Frame Rate)	Shooting Time		
		32 MB (supplied)	2 GB	8 GB
		15 sec.	16 min. 47 sec.	1 hr. 7 min. 6 sec.
		30 sec.	33 min. 2 sec.	2 hrs. 12 min. 3 sec.
		43 sec.	46 min. 33 sec.	3 hrs. 6 min. 4 sec.
		3 min. 30 sec.	3 hrs. 24 min. 54 sec.	13 hrs. 38 min. 45 sec.

- The figures in this table depend on Canon measuring conditions.
- Max. clip length for is approx. 1 hour. Recording also stops when the file size reaches 4 GB.
- Depending on the memory card, recording may stop even if the max. clip length has not been reached. Use of SD Speed Class 4 or higher memory cards is recommended.
- Max. clip length for is approx. 3 minutes. The figures above indicate the max. continuous recording time.

## Shooting Movies With Fixed Exposure Settings

Before shooting, you can lock (AE Lock) or change the exposure (Exposure Shift).



Exposure Shift Bar

### 1 Lock the exposure.





- Pressing the button will lock the exposure, and the exposure shift bar will appear.

### 2 Adjust the exposure.

- Adjust the exposure with the .
- After shooting, press the button to cancel.

## Other Shooting Functions

The following functions can be used in the same way as for still images.









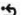

-  **Using the Self-Timer** (p. 60)
- **Zooming in on Far Away Subjects** (p. 61)  
In , you can use the digital zoom, but the optical zoom cannot be used.  
If you want to shoot at the maximum magnification, you should adjust the optical zoom to the maximal factor before shooting.
-  **Shooting Close-ups (Macro)** (p. 64)
-  **Shooting Far Away Subjects** (p. 65)
- **Adjusting the Tone (White Balance)** (p. 73)
- **Changing the Tone of an Image (My Colors)** (p. 75)
- **Shooting Using a TV** (p. 77)
- **AF Lock Shooting with AF Lock** (p. 85)

## Playback Functions

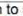
The following functions can be used in the same way as for still images.

- **Erasing Images** (p. 25)
- **Quickly Finding Images** (p. 94)
-  **Organizing Images by Category (My Category)** (p. 96)
-  **Viewing Slideshows** (p. 98)
- **Viewing Images on a TV** (p. 100)
-  **Erasing All Images** (p. 101)
-  **Protecting Images** (p. 102)

### Summary for Viewing Movies (p. 30)

	Exit playback and return to single image playback.
	Print (Refer to the <i>Direct Print User Guide</i> )
	Playback
	Slow Motion Playback (you can use the  button to slow down, or the  button to speed up playback. Sound will not play back.)
	Display the first frame
	Previous frame (Rewind if you hold down the  button.)
	Next frame (Fast forward if you hold down the  button.)
	Display the last frame

# 7

## Using Various Playback and Other Functions

This chapter explains how to play back and edit images.

It also explains how to transfer images to a computer and how to make settings for printing.

- Press the  button to set the Playback mode, before operating the camera.



Images edited on a computer, changed file names, or taken with a different camera may not display correctly.



## Displaying 9 Images (Index Playback)

Displaying 9 images at a time lets you quickly find the image you want.



### 1 Select Index Playback.

- Move the zoom lever toward .
- ▶ Images will display in an index. The selected image will have a green frame and be enlarged.



### 2 Select an image.

- Press the buttons to move the green frame.

### 3 Display only the selected image.

- Move the zoom lever toward .
- ▶ The image in the green frame will display in Single Image Playback.

## Searching 9 Images at a Time



Jump Bar

### 1 Select Index Playback.

- Move the zoom lever toward .

### 2 Display the Jump bar.

- Move the zoom lever toward .
- ▶ The jump bar appears.

### 3 Change the displayed images.

- Press the buttons to switch between displays of 9 images.
- To return to Index Playback, move the zoom lever toward .



Holding the button and pressing the buttons will jump to the first or last set of images.

## Jumping to Images (Jump Display)

When you have many images on a memory card, you can jump to images using a search key.



### 1 Select a search key.

- In Single Image Playback, press the button.
- ▶ The search key and the position of the currently displayed image will appear at the bottom of the screen.
- Press the buttons to select the desired search key.



Position of the Currently Displayed Image

### 2 Jump to an image.

- Press the buttons.
- ▶ The camera will use the selected search key to jump to an image.
- To return to Single Image Playback, press the button.

	Jump Shot Date	Jumps to the first image of each shooting date.
	People	Jumps to the images of each category, sorted with My Category (p. 96).
	Scenery	
	Events	
	Category 1-3	
	To Do	
	Jump to Folder	Jumps to the first image of each folder.
	Jump to Movie	Jumps to a movie.
	Jump 10 Images	Jumps over 10 images at a time.
	Jump 100 Images	Jumps over 100 images at a time.



- With search keys other than and , the number of images matching the search key will display on the right side of the screen.
- The desired search key may not display at the bottom of the screen, if there are no images that match that search key.

## Organizing Images by Category (My Category)

You can sort images into pre-set categories and organize by category.

	People		Category 1-3
	Scenery		To Do
	Events		



### 1 Select [My Category].

- Press the button, select the tab. Press the buttons to select [My Category], then press the button.

### 2 Categorize the images.

- Press the buttons to select an image. Press the buttons to select a category, then press the button.
- Pressing the button again cancels the setting.

## Auto Category during Shooting

Images are automatically sorted when shot, as shown in the following table.

People	For images shot in ,  or  mode, or images with faces detected when [AF Frame] (p. 80) is set to [Face Detect].
Scenery	For images shot in ,  or  mode.
Events	For images shot in , ,  or  mode.

- If you do not wish to categorize the images automatically, select the tab, choose [Auto Category] and set it to [Off].

## Magnifying Images



Approximate Location of Displayed Area

### Magnify an image.

- In Single Image Playback, move the zoom lever toward and hold it there. will display, and the image will be magnified up to approx. 10 times.
- If you press the , you can move the location of the displayed area.
- Move the zoom lever toward to reduce the magnification or return to Single Image Playback.
- If you press the button, will display. Press the buttons to switch between images at the same level of magnification. Press the button again to return to normal.



## Viewing Slideshows

You can automatically playback images recorded to a memory card. Each image displays for approximately 3 seconds.



### 1 Select [Slide Show].

- Press the button, select the tab. Press the buttons to select [Slide Show], then press the button.

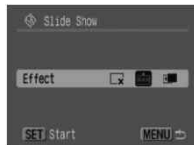

### 2 Select a transition effect.

- Press the buttons to select a transition effect, then press the button.
- ▶ A few seconds after "Loading image..." displays, the slideshow will start.
- You can pause/restart a slideshow by pressing the button again.
- Press the button to stop the slideshow.

	Images display without transition effect.
	The next image displays gradually.
	The image slides out to the left and the next image appears.

- If you press the buttons during a slideshow, the image will change (if you hold the buttons pressed, the images move faster).
- Power saving function does not work during slideshows (p. 42).

## Checking the Focus and People's Expressions (Focus Check Display)

You can check the focus or people's expressions of an image taken.

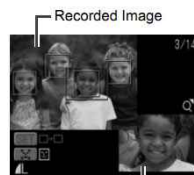

Orange frame contents



### 1 Display the Focus Check screen.

- Press the button several times until the focus check screen appears.
- ▶ The recorded image displays with the AF frame (frame with the subject in focus), the face frame (white frame around a face) or gray frames (around faces detected during playback).
- ▶ The orange frame shows the range of the image displayed at the bottom right of the screen.

### 2 Checking the focus.

- Move the zoom lever toward .
- ▶ The content of the orange frame displays magnified at the bottom right of the screen.
- Use the zoom lever to change the display size, and the buttons to change the display position, while checking the focus.
- Press the button to close the magnified display.

### When multiple frames display

When multiple frames display, press the or button to switch frames. Each time you press either button changes the position of the orange frame.

## Viewing Images on a TV

Using the supplied AV cable, you can connect the camera to a TV to view images you have shot.

### Items to Prepare

- Camera and TV
- AV cable supplied with the camera (p. 2)

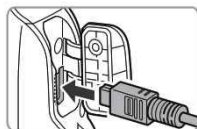

#### 1 Turn off the camera and TV.

#### 2 Connect the camera to the TV.

- Open the camera's cover and insert the plug of the supplied AV cable into the camera's A/V OUT terminal.
- Insert the other end plugs into TV's video input terminals as shown in the illustration.

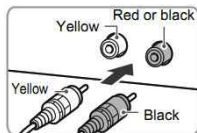

#### 3 Turn on the TV and switch it to video mode.

#### 4 Turn on the camera.

- Press the button to turn on the camera.
- ▶ The image will appear on the TV (nothing will appear on the screen of the camera).
- After you finish viewing, turn off the camera and TV, and unplug the AV cable.



### ? What if no image displays on the TV?

If the camera's video output system (NTSC/PAL) does not match the TV's, images will not display correctly. If this happens, press the button, select the tab, and then use the [Video System] menu item to switch to the correct video system.

## Changing Image Transitions

You can select from three transition effects when switching between images in Single Image Playback.

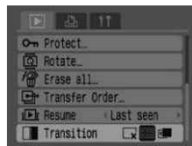

### Select [Transition].

- Press the button, select the tab, and then select [Transition] and use the buttons to select the desired transition.

	Immediately switches between images without transition effect.
	Displayed image fades out as next image fades in.
	Slides images left to switch between images.

## Erasing All Images

In addition to selecting and erasing images one at a time, you can erase all images at once. Since erased images cannot be recovered, exercise adequate caution before erasing images. However, protected images cannot be erased.

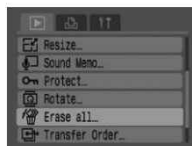

Erase all

Erase all images?

Cancel OK

### 1 Select [Erase all].

- Press the button, select the tab. Press the buttons to select [Erase All], then press the button.

### 2 Erase all images.

- Press the buttons to select [OK], then press the button.
- ▶ All images on the memory card will be erased.

## Protecting Images

You can protect important images so that they will not be erased inadvertently.



### 1 Select [Protect].

- Press the button, select the tab. Press the buttons to select [Protect], then press the button.



### 2 Protect the image.

- Press the buttons to select an image, then press the button.
- ▶ Protected images display on the screen.
- Press the button again to cancel protection, and the will disappear.
- To protect additional images, repeat the above procedure.



If you format the memory card (p. 49), protected images will also be erased.



- Protected images cannot be erased with the camera's erase function. To erase an image, cancel protection first.
- If you select [Erase all] (p. 101) after protecting necessary images, all other images will be erased. This is a convenient way of erasing unneeded images.

## Resizing Images

You can resave images that were recorded at high recording pixel settings as a new lower pixel file.



### 1 Select [Resize].

- Press the button, select the tab. Press the buttons to select [Resize], then press the button.

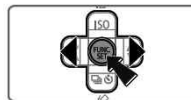

### 2 Select an image.

- Press the buttons to select an image, then press the button.



### 3 Select an image size.

- Press the buttons to select a setting, then press the button.



### 4 Save the new image.

- Press the buttons to select [OK], then press the button.
- ▶ The image will be saved as a new file.

### 5 Display the new image.

- When you press the button, [Display new image?] displays. Press the buttons to select [Yes], then press the button.
- ▶ The saved image will display.





- You cannot resize an image if there is not enough free space on the memory card.
- Movies and images shot in **W** cannot be resized.



You cannot resize an image to a larger size.



## Rotating Images

Images taken with the camera held vertically can be rotated when viewing them horizontally.



### 1 Select [Rotate].

- Press the **MENU** button, select the **[T]** tab. Press the **▲▼** buttons to select [Rotate], then press the **[FUNC/SET]** button.



### 2 Rotate the image.

- Press the **◀▶** buttons to select an image, then press the **[FUNC/SET]** button.
  - Cycle through the 90°/270°/original orientations with each press of the **[FUNC/SET]** button.



## Correcting Red-Eye Effect

You can automatically correct images with red-eye and save those images as new files.

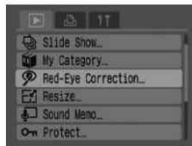

### 1 Select [Red-Eye Correction].

- Press the **MENU** button, select the **[T]** tab. Press the **▲▼** buttons to select [Red-Eye Correction], then press the **[FUNC/SET]** button.



### 2 Select an image to correct.

- Press the **◀▶** buttons to select an image, then press the **[FUNC/SET]** button.
  - A frame will appear on red-eye detected by the camera.



### 3 Correct the image.

- Press the **◀▶** buttons to select [Start], then press the **[FUNC/SET]** button.

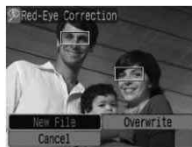

### 4 Save the new image.

- Press the **◀▶** buttons to select [New File], then press the **[FUNC/SET]** button.
  - The image will be saved as a new file.

### 5 Display the new image.

- When you press the **MENU** button, [Display new image?] displays. Press the **◀▶** buttons to select [Yes], then press the **[FUNC/SET]** button.
  - The saved image will display.

## Manual Correction

When the camera cannot automatically detect and correct red-eye, correct it manually.



### 1 Add a correction frame.

- In Step 3 on the previous page, select [Add Frame] and then press the button.



### 2 Set the position and size.

- Press the , , , and buttons to move the correction frame (green) to the red-eyes, then use the zoom lever to adjust its size so only the red-eyes are framed.
- ▶ The area inside the frame will appear enlarged in the bottom right of the screen.
- When you press the button, the first frame will be set (white) and a new frame will appear.
- When you have set the frame positions and sizes, press the button, then follow Steps 3 and 4 on the previous page.
- You can add up to 35 correction frames.

## Removing Frames

- In Step 3 on the previous page, select [Remove Frame] and then press the button.
- Press the and buttons to select a frame, then press the button.
- Press the button, then follow Steps 3 and 4 on the previous page.



- Some images may not be properly corrected.
- If there is not enough free space on the memory card, red-eye cannot be corrected.
- If you repeat corrections on the same image, image quality may deteriorate.
- When [Overwrite] in Step 4 on the previous page is selected, the uncorrected image is overwritten with the corrected data, erasing the original image.
- Protected images cannot be overwritten.



## Attaching Sound Memos

You can record and attach a sound memo (WAVE format) to an image. The attached sound memo can be up to approximately 1 minute long per image.



### 1 Select [Sound Memo].

- Press the button, select the tab. Press the and buttons to select [Sound Memo], then press the button.



### 2 Select an image.

- Press the and buttons to select an image, then press the button.



### 3 Record the memo.

- Press the and buttons to select (a circle with a dot), then press the button.
- ▶ Recording starts.
- You can pause/restart recording by pressing the button.
- If you want to stop recording, press the and buttons to select (a square with a dot), then press the button.

## Sound Memo Operation Panel

	Exit		Record
	Pause		Play
	Delete		



- The sound attached to an image can also be played with the supplied software.
- Sound memos cannot be deleted from protected images.

## Transferring Images to a Computer

"Transferring Images with the Camera" (p. 35) in Chapter 1 explained how to transfer images using [New Images]. This section will explain other ways to transfer images.



### 1 Prepare.

- Follow Steps 2–4 on page 33 to display Direct Transfer menu.

### 2 Select a setting.

- Press the  $\blacktriangle$ / $\blacktriangledown$  buttons to select a setting.

### 3 Transfer the images.

In and

- Press the button.
- ▶ The camera returns to the Direct Transfer menu once transferring is complete.

In and

- Press the button, then use the  $\blacktriangleleft$ / $\blacktriangleright$  buttons to select an image and press the button again.
- ▶ Images matching the selected setting will be transferred.
- Press the button to return to the Direct Transfer menu.

## Direct Transfer Settings

All Images	Transfers all images from the memory card to the computer.
New Images	Transfers all new images that have not been transferred to the computer before (p. 35).
DPOF Trans. Images	Transfers all images designated for transfer at once (p. 109).
Select & Transfer	Select and transfer images one at a time.
Wallpaper	Select and transfer an image to use as your computer desktop's background (wallpaper). (JPEG only)

To cancel while transferring, press the button.

## Designating Images for Transfer (DPOF)

You can designate images you want to transfer with [DPOF Trans. Images] (p. 108). These designation methods comply with the DPOF (Digital Print Order Format) standards.

## Designating Images Individually

### 1 Select [Transfer Order].

- Press the button, select the tab. Press the  $\blacktriangle$ / $\blacktriangledown$  buttons to select [Transfer Order], then press the button.



### 2 Select [Order].

- Press the  $\blacktriangleleft$ / $\blacktriangleright$  buttons to select [Order], then press the button.

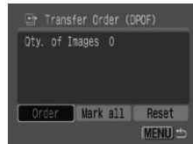

### 3 Select an image.

- Press the  $\blacktriangleleft$ / $\blacktriangleright$  buttons to select an image, then press the button.
- ▶ After designating an image displays.
- Press the button again to cancel designation, the will disappear.
- Repeat the above procedure to designate other images. Up to 998 images can be designated.
- Pressing the button twice will save the settings to the memory card and return you to the menu screen.



## Designating All Images



### 1 Select [Transfer Order].

- Press the **MENU** button, select the **Transfer** tab. Press the **▲▼** buttons to select [Transfer Order], then press the **OK** button.

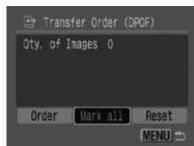

### 2 Select [Mark all].

- Press the **◀▶** buttons to select [Mark all], then press the **OK** button.
- Press the **◀▶** buttons to select [OK], then press the **OK** button.
- ▶ All images will be designated together.

## Reset All

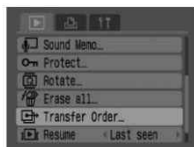

### 1 Select [Transfer Order].

- Press the **MENU** button, select the **Transfer** tab. Press the **▲▼** buttons to select [Transfer Order], then press the **OK** button.

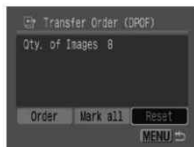

### 2 Select [Reset].

- Press the **◀▶** buttons to select [Reset], then press the **OK** button.
- Press the **◀▶** buttons to select [OK], then press the **OK** button.
- ▶ All transfer orders are removed.



may display when using a memory card with transfer settings set by a different camera. If you change settings with this camera, the previously made settings may be overwritten.

## Designating Images for Printing (DPOF)

You can make print settings to images on a memory card (up to 998 images), such as which images to print and how many prints to make. These designation methods comply with the DPOF (Digital Print Order Format) standards.

## Using the **Print** Button to Add to Print List

Display the image you wish to print and simply press the **Print** button to add it to the Print List (DPOF).

### 1 Select an image.

- Press the **◀▶** buttons to select an image, then press the **Print** button.



### 2 Set the number of prints.

- Press the **▲▼** buttons to set the number of prints.

### 3 Add to Print List

- Press the **◀▶** buttons to select [Add], then press the **OK** button.
- ▶ The **Print** icon and the number of prints display.
- If you want to remove an image from the Print List, display the image you wish to remove. Press the **Print** button, use the **◀▶** buttons to select [Remove], then press the **OK** button.

## Printing from the Print List (DPOF)

You can easily print the selected images, after setting the Print List (DPOF) and connecting the camera with a printer. Also refer to the *Direct Print User Guide*.

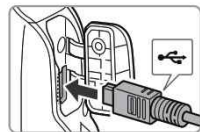

### 1 Turn off the camera and printer.

### 2 Connect the camera and printer.

- Open the cover and insert the smaller plug of the cable into the camera's terminal, as shown.
- Insert the bigger plug into the printer's terminal. Refer to the printer's user guide about how to connect the printer.



### 3 Turn on the printer.

### 4 Turn on the camera.

### 5 Printing.

- Press the  $\blacktriangle$   $\blacktriangledown$  buttons to select [Print now], then press the  $\text{FUNC}$  button.
- ▶ Printing starts.
- Press the  $\blacktriangle$   $\blacktriangledown$  buttons to check the images in the Print List.



## Selecting Images

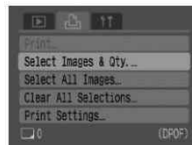

### 1 Select [Select Images & Qty.].

- Press the  $\text{MENU}$  button, select the  $\text{Print}$  tab. Press the  $\blacktriangle$   $\blacktriangledown$  buttons to select [Select Images & Qty.], then press the  $\text{FUNC}$  button.



### 2 Select an image.

- Press the  $\blacktriangle$   $\blacktriangledown$  buttons to select an image, then press the  $\text{FUNC}$  button.
- ▶ You will be able to set the number of print copies.
- If you select [Index],  $\checkmark$  appears on the screen.



### 3 Set the number of prints.

- Press the  $\blacktriangle$   $\blacktriangledown$  buttons to set the number of prints (maximum 99).
- Repeat Steps 2 and 3 to set other images and the number of prints.
- For [Index], you cannot set the number of prints. Only select images.

## Set All Images to Print One Each

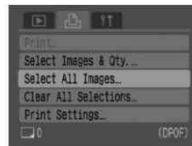

### 1 Select [Select All Images].

- Press the  $\text{MENU}$  button, select the  $\text{Print}$  tab. Press the  $\blacktriangle$   $\blacktriangledown$  buttons to select [Select All Images], then press the  $\text{FUNC}$  button.





## 2 Make the settings.

- Press the buttons to select [OK], then press the button.
- ▶ One copy of every image will be set to print and you will return to the menu screen.

## Clearing all Selections

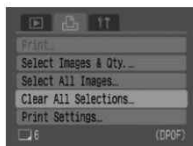

### Select [Clear All Selections].

- Press the button, select the tab. Press the buttons to select [Clear All Selections], then press the button.
- Press the buttons to select [OK], then press the button.
- ▶ All selections will be cleared.

## Print Settings

You can make settings for the print type, date and file number. These settings apply to all selected images, and cannot be set individually.

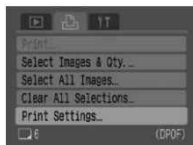

## 1 Select [Print Settings].

- Press the button, select the tab. Press the buttons to select [Print Settings], then press the button.

## 2 Make the settings.

- Press the buttons to select an item, then use the buttons to select a setting.

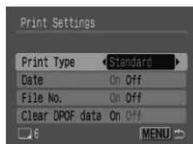

Print Type	Standard	Prints one image per page.
	Index	Prints several reduced size images per page.
	Both	Prints both standard and index formats.
Date	On	Prints date from shooting information.
	Off	—
File No.	On	Prints file number.
	Off	—
Clear DPOF data	On	Clears all print settings after printing.
	Off	—



- Depending on the printer or photo developer, print settings may not be reflected.
- may display when using a memory card with transfer settings set by a different camera. If you change settings with this camera, the previously made settings may be overwritten.
- Images with the date embedded using (p. 63), always print with the date, regardless of the [Date] setting. As a result, some printers may print the date twice on these images if [Date] is also set to [On].



- When set to [Index], [Date] and [File No.] cannot be set to [On] at the same time.
- The date will print in the style set in [Date/Time] in the tab (p. 19).

## Customizing the Camera

This chapter expands on the normal usage of the camera by explaining how to set useful functions, and change shooting mode settings.

---

## Changing Functions

The functions listed in the **↑↑** tab are useful functions that you can set for normal usage. You can set them in the Shooting or Playback mode, by pressing the **MENU** button.

### Turning Off the Start-up Image

You can turn off the start-up image that displays when you turn on the camera.

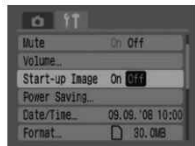

- Select [Start-up Image], then press the **◀▶** buttons to select [Off].

### Turning off the Power Saving Function

You can set the power saving function (p. 42) to [Off]. However, setting to [On] is recommended to save battery power.



- Choose [Power Saving], then press the **↑** button.
- Press the **▲▼** buttons to select [Auto Power Down], then use the **◀▶** buttons to select [Off].
- If you set [Auto Power Down] to [Off], be careful not to forget to turn off the camera after use.

## Power Saving during Shooting

You can change the time at which the screen shuts down automatically during shooting (p. 118). This also works when [Auto Power Down] is set to [Off].

In order to save battery power, it is recommended to choose less than [1min.].



- Choose [Power Saving], then press the **↑** button.
- Press the **▲▼** buttons to select [Display Off], then use the **◀▶** buttons to select a time.

## Changing the File Number Assignment

Images you shoot are automatically assigned file numbers, in the order they were taken, from 0001 – 9999, and saved to folders of up to 2000 images. You can change the file number assignment.

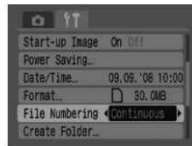

- Select [File Numbering], then press the **◀▶** buttons to select a setting.
- [Continuous]: Even if you shoot using a new memory card, the file numbers are assigned consecutively until an image with the number 9999 is taken/saved.  
[Auto Reset]: If you replace the memory card with a new one, file numbers are assigned starting with 0001 consecutively.





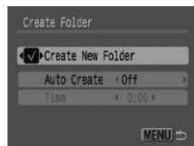

- For either setting [Continuous] or [Auto Reset], if you use a memory card already containing images, the newly assigned file numbers may continue the existing numbering. If you want to start over with file number 0001, format the memory card before use (p. 49).
- Refer to the *Software Starter Guide* for information regarding folder structure or image type.

## Creating a Folder

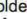
You can create new folders to save your images to.





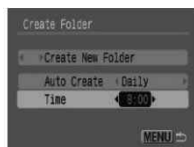

- Select [Create Folder], then press the .
- Press the  buttons to select [Create New Folder], then press the  buttons to select .
- ▶ When in Shooting mode, the  displays. Newly shot images are now saved to the new folder.

## Creating Folders by Day and Time

You can set a day and time for folder creation.

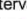

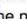
- Select [Create Folder], then press the .
- Press the  buttons to select [Auto Create], then press the  buttons to select an interval.
- Press the  buttons to select [Time], then press the  buttons to set a time.
- ▶ The new folder will be created on the set day and time. Images shot after the creation date are saved to the new folder.

## Turning off Auto Rotate

When you play back images on the camera, images shot in vertical orientation automatically rotate and display vertically. You can turn off this function.

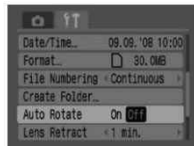

- Select [Auto Rotate], then press the  buttons to select [Off].

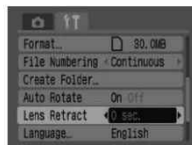

## Changing the Lens Retract Time

The lens retracts about 1 minute after switching to Playback mode, for safety reasons. You can set the retract time to [0 sec.].



- Select [Lens Retract], then press the  buttons to select [0 sec.].



## Changing Shooting Functions

You can set functions in the  tab after pressing the  button while in Shooting mode. Some functions may not be available, depending on the shooting mode. Refer to the  (Shooting) Tab Menu section (p. 136).

## Using the Slow Synchro

Shoot with the flash and a slow shutter speed. Lightens dark backgrounds when shooting night sceneries or indoors using a flash. You can use Slow Synchro to get the same results as with  (p. 57).

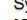

- Select [Flash Settings], then press the .
- Press the  buttons to select [Slow Synchro], then press the  buttons to select [On].



In order to reduce camera shake, attach the camera to a tripod so that it does not move. When you attach the camera to a tripod, you are recommended to set [IS Mode] to [Off] to shoot (p. 124).

## Using the Auto Red-Eye Correction Function

This function automatically reduces red-eye. Only the corrected image will be recorded to the memory card.

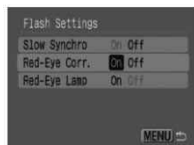

- Select [Flash Settings], then press the button.
- Press the buttons to select [Red-Eye Corr.], then press the buttons to select [On].



- Red-eye correction may be applied to other red parts than red eyes. For example, when red make-up has been used around eyes.
- Depending on the image, red-eye may not be detected automatically and correction may not be applied as you expected. If this occurs, select in the tab the [Red-Eye Correction] to apply correction (p. 105).

## Turning off the Red-Eye Lamp

The lamp lights in order to reduce the red-eye effect that occurs when shooting in dark conditions using the flash. You can turn off this function.

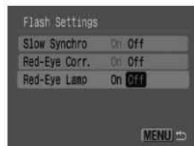

- Select [Flash Settings], then press the button.
- Press the buttons to select [Red-Eye Lamp], then press the buttons to select [Off].

## Turning off the AF-Assist Beam

When the camera has focusing difficulties while you press the shutter button halfway, the AF-assist Beam will automatically light to assist focusing. You can turn off this function.

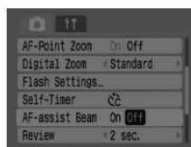

- Select [AF-assist Beam], then press the buttons to select [Off].

## Displaying the Overlay

You can display grid lines for vertical and horizontal guidance, or 3:2 guide to confirm the printable area for L size or postcard size prints.

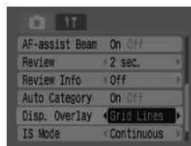

- Select [Disp. Overlay], then press the buttons to select a setting.
- [Grid Lines]: A grid overlays the display.  
[3:2 Guide]: The areas outside the 3:2 range are grayed out.  
These areas will not print when printing on paper of 3:2 aspect ratio.



- In , and modes, you cannot set [3:2 Guide] and [Both].
- Grid lines will not be recorded on the image.
- The gray areas on the top and bottom of the screen will not be printed; however, the entire image displayed will be recorded.



## Changing the Image Stabilization (IS Mode)

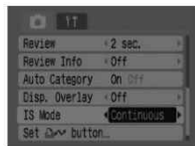

- Select [IS Mode], then press the **◀▶** buttons to select a setting.
- [Continuous]: The image stabilization is always on. You can confirm the result directly on the screen which makes it easier to check the composition or focus of the subject.  
[Shoot Only]: The image stabilization is only on in the moment of shooting.  
[Panning]: The image stabilization only works for the effect of up and down motion. This option is recommended for shooting objects moving horizontally.



- If camera shake is too strong, fix the camera to a tripod. When you attach the camera to a tripod, you are recommended to set [IS Mode] to [Off] to shoot.
- When using [Panning], make sure to hold the camera horizontally. The Image Stabilization does not work when the camera is held vertically.

## Registering Functions to the **Fn** Button



- Select [Set **Fn** button], then press the **Fn** button.
- Press the **▲▼◀▶** buttons to select the functions to register, then press the **Fn** button.
- When you press the **Fn** button, you can use the registered function or display the setting screen for the selected function.



- Select **Fn** if you want to cancel a function.
- When this **⊘** symbol is shown on the bottom right of an icon, the function cannot be used in the current shooting mode.
- In **WB**, each press of the **Fn** button records white balance data (p. 73), and the white balance settings also change to **WB**.

# 9

## Useful Information for Using the Camera

This chapter introduces camera accessories, contains lists of functions and the index.

## Using Household Power

If you use AC Adapter Kit ACK800 (sold separately), you can use the camera without worrying about how much charge is left in the batteries.

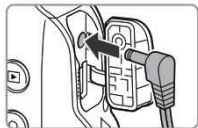

### 1 Turn the camera off.

### 2 Plug the cord into the camera.

- Open the camera's terminal cover and insert the plug into the camera.

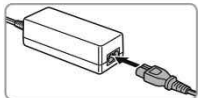

### 3 Connect the power cord.

- Connect the power cord to the compact power adapter, then plug the other end into a power outlet.
- You can turn the camera on to use it.
- After you finish, turn off the camera and unplug the power cord from the power outlet.



Do not unplug the power cord with the camera turned on. This could erase images you have taken or damage the camera.

## Using a Supplementary Flash

High-Power Flash HF-DC1 (sold separately) is used to supplement the camera's built-in flash when the subject is too far away for proper illumination. For details on attaching and using the High-Power Flash, refer to the user guide provided with the flash.

## Handling Precautions

### Equipment

- This camera is a high-precision electronic device. Do not drop it or subject it to strong impact.
- Never place the camera close to magnets or motors that generate strong electromagnetic fields. Exposure to strong magnetic fields may cause malfunctions or corrupt image data.
- If water droplets have fallen or dirt is stuck on the camera or LCD monitor, wipe with a dry soft cloth or eyeglass wiper. Do not rub or apply force.
- Never use cleaners including organic solvents to wipe the camera or LCD monitor.
- Use a commercially available blower brush to remove dust from the lens. For stubborn dirt contact the closest Canon Customer Support Help Desk as listed on the customer support leaflet supplied with your camera.
- When you move the camera rapidly from cold to hot temperatures, condensation may form on the internal or external surfaces of the camera. To avoid condensation, put the camera in an airtight, resealable plastic bag and let it adjust to temperature changes slowly before removing it from the bag.
- When condensation has formed, stop using the camera immediately. Continued use may damage the camera. Remove the batteries and memory card, and wait until the moisture has completely evaporated before resuming use.

### Memory Cards

- Memory cards are high-precision electronic devices. Do not bend, apply force or subject to strong impact. Doing so may corrupt image data recorded on the memory card.
- Do not spill liquids on the memory card. Do not touch the memory card's terminals with your hands or metallic objects.
- Do not store memory cards near a TV, speakers or other devices that generate magnetism or static electricity. Doing so may corrupt image data recorded on the memory card.
- Do not store memory cards in hot, humid or dusty locations.

If you think there is a problem with the camera, first check the following. If the items below do not solve your problem, contact a Canon Customer Support Help Desk as listed on the included customer support list.

## Power

### You pressed the power button, but nothing happened.

- Confirm that the batteries are properly inserted (p. 14).
- Confirm that the memory card slot/battery cover is securely closed (p. 15).
- Confirm that the batteries are charged (p. 16).
- Clean the terminals with a cotton swab and re-insert the batteries several times.

### Batteries are consumed quickly.

- Confirm that you are using the correct battery type (p. 16).
- In low temperatures, battery performance may be weak. Warm the batteries, such as by placing them in your pocket.
- If the battery terminals have become dirty, battery performance may be weak. Clean the terminals with a cotton swab and re-insert the batteries several times.

### Lens will not retract.

- Do not open the memory card slot/battery cover while the power is on. After closing the cover, turn the power on then back off (p. 14).

## TV output

### Image is distorted or not showing on TV.

- Set the video setting, NTSC or PAL, for your TV (p. 100).

## Shooting

### Screen does not display.

- Press the  button to turn on the screen (p. 45).

### Screen does not display properly while shooting.

- The display automatically brightens when shooting in dark conditions. Noise may appear and the movement of the subject on the screen may appear somewhat jagged. This has no effect on the recorded image (p. 45).

The following situations will not record on still images but will record on movies.

- When the camera is subjected to powerful light sources, the display may darken.
- Under fluorescent lighting, the screen may flicker.
- When shooting bright light sources, a bar of light (purplish red) may appear on the screen.

### Display turned off while shooting.

- When the flash has finished charging, the display will return (p. 23).

### appears when the shutter button was pressed halfway.

- Set the IS Mode to [Continuous] (p. 124).
- Set the flash to any setting other than  (p. 59).
- Increase the ISO speed (p. 72).
- Attach the camera to a tripod so that the camera does not move.

### Image is blurred.

- Press the shutter button halfway to focus on the subject, then press fully to shoot (p. 21).
- Shoot the subject within the focusing distance (p. 140).
- Refer to " appears when the shutter button was pressed halfway" above.
- Set the AF-assist Beam to [On] (p. 123).
- Confirm that functions which you do not intend to use (macro, etc.) are not set.
- Shoot using the focus lock or AF lock (p. 85).

### Even when you press the shutter button halfway, the frame does not appear, and the camera does not focus.

- If you center on the light and dark contrasting area of the subject and press the shutter button halfway, or repeatedly press the shutter button halfway, the frame will appear and the camera will focus.

### Subject is too dark or too bright (overexposed).

- Set the flash to  (p. 59).
- Adjust the brightness with exposure compensation (p. 74).
- Use the AE lock, or spot metering to shoot (pp. 85, 86).
- The subject is too bright due to ambient lighting.

### Image is dark even though the flash fired.

- Shoot within an appropriate distance for flash photography (p. 140).
- Increase the ISO speed (p. 72).

### Subject in an image taken using the flash is too bright (overexposed).

- Shoot within an appropriate distance for flash photography (p. 140).
- Set the flash to  (p. 59).

### White dots appear on the image when shooting with the flash.

- Light from the flash has reflected off dust particles or other objects in the air.

### Image appears rough or grainy.

- Shoot with the ISO speed on a lower setting (p. 72).
- Depending on the shooting mode the ISO speed may be high and the image may appear rough or grainy (pp. 55, 58).

**Eyes appear red.**

- Set [Red-Eye Lamp] to [On]. This is effective if the subject looks right at the red-eye reduction lamp. Even better results can be obtained by increasing the lighting in indoor settings or approaching closer to the subject. The shutter will not close for approx. 1 second when the lamp lights (p. 23).
- You can set the [Red-Eye Corr.] to [On] to automatically correct red-eye while shooting. You can also make corrections after the image is taken, using [Red-Eye Correction] (pp. 105, 122).

**Image seen in the viewfinder and the recorded image are slightly different.**

- You can check the actual image size on the screen (p. 45). If you use Macro mode, the difference is even stronger. Use the screen to compose the image.

**Recording images to the memory card takes a long time, or continuous shooting slows down.**

- Low-level formatting the memory card in the camera may solve the problem (p. 50).

**Cannot set shooting functions or Func. menu settings**

- Depending on the shooting mode, available functions vary. Refer to the Functions Available in Each Shooting Mode section (p. 134).

**Shooting movies****Recording time does not display correctly or shooting stops unexpectedly.**

- Format the memory card in the camera, or use a memory card capable of recording at high speeds. Even if the recording time is not displayed correctly, the movie will be recorded correctly on the memory card (pp. 29, 49).

**< ! > displayed on the screen, and shooting ended automatically.**

- Camera's internal memory was insufficient. Try one of the following measures.
- Low-level format the memory card in the camera (p. 50).
- Lower the number of recording pixels (p. 90).
- Use a memory card capable of recording at high speeds.

**Zoom does not operate.**

- Zoom before shooting movies. In  mode, you can also use the digital zoom (p. 90).

**Playback****Cannot play back.**

- If the file name or folder structure is changed on a computer, you may not be able to play back images or movies. Refer to the *Software Starter Guide* for information regarding folder structure or file names.

**Playback stops, or audio cuts out.**

- Use a card that has been formatted on this camera (p. 49).
- If you copy a movie to a memory card that reads slowly, playback may interrupt momentarily.
- When playing movies on your computer, depending on the computer's capabilities, it may drop frames, or the audio may cut out.

**Cannot operate buttons or zoom lever.**

- When the mode dial is set to Easy mode, some buttons and the zoom cannot be used (p. 54).

**List of Messages****Messages appear on the screen.**

- Refer to the Error Messages section (p. 132).



If error messages appear on the screen, try one of the following solutions.

## No memory card

- The memory card may be inserted in the wrong orientation. Insert the memory card in the correct orientation (p. 14).

## Card locked!

- The SD memory card or SDHC memory card's write protect tab is set to "Lock". Unlock the write protect tab (pp. 14, 17).

## Cannot record!

- You attempted to shoot an image without a memory card installed or with a memory card installed in the wrong orientation (p. 14).
- You cannot attach sound memos to movies.

## Memory card error

- The memory card is malfunctioning. Formatting the memory card may solve the problem (p. 49). If this error message appears even when using the supplied memory card, contact your Canon Customer Support Help Desk as there may be a problem with the camera.

## Memory card full

- There is not enough free space on the memory card. Erase the images (pp. 25, 101) to open space for new images, or insert an empty memory card (p. 14).

## Change the batteries

- Battery charge is low. Change the batteries (p. 16).

## No Image.

- There are no images recorded on the memory that can be displayed.

## Protected!

- Protected images, movies or sound memos cannot be erased. Remove protection before erasing (p. 102).

## Unidentified Image/Incompatible JPEG/Image too large./RAW

- Unsupported images or data, or corrupted image data cannot be displayed.
- Images manipulated on a computer, that have had their file name changed, or have been taken with a different camera may not display.

## Cannot magnify!/Cannot rotate/Cannot modify image

- Unsupported images cannot be magnified (p. 97), rotated (p. 104) or edited (pp. 103, 105).
- Images manipulated on a computer, that have had their file name changed, or have been taken with a different camera may not be magnified, rotated or edited.
- Movies cannot be magnified (p. 97) or edited (pp. 103, 105)

## Incompatible WAVE

- Since the data type of the existing sound memo is incorrect., no new sound memo can be added or played back (p. 107).

## Naming error!

- The file name could not be created because there is an image with the same name as the folder that the camera is attempting to create, or the highest possible file number has already been reached (p. 120). In the **FILE** tab, set [File Numbering] to [Auto Reset] (p. 119) or format the memory card (p. 49).

## Cannot transfer!

- Unsupported or corrupted image data cannot be transferred, even when set in Direct Transfer (pp. 34, 108).
- Movies selected in [Wallpaper] cannot be transferred (p. 108).

## Too many marks

- The number of images for print settings or transfer settings exceeds 998. Set 998 or less images for print or transfer (pp. 109, 111).

## Cannot complete!

- Print settings or transfer settings could not be saved correctly. Reduce the number of settings and try again (pp. 109, 111).

## Unselectable image

- Unsupported images cannot be set for printing (p. 111).
- Images manipulated on a computer, that have had their file name changed, or have been taken with a different camera may not be supported.

## Communication error

- Images could not be transferred to the computer due to the large amount of images (approx. 1000) stored on the memory card. Use a commercially available USB card reader to transfer the images.













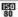

## Lens error, restart camera



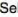









- A lens error was detected. Press the power button to turn the camera off and back on (p. 22). If this error message continues to display, contact your Canon Customer Support Help Desk as there may be a problem with the lens.
- This error can occur if you hold the lens while it is in motion or when using it in a location with excessive dust or sand in the air.

## Exx (xx: number)

- Camera detected an error. Press the power button to turn the power off and then back on (p. 22). If an error code displays directly after taking a picture, the shot may not have been recorded. Check image in playback mode.
- If this error code reappears, note the number and contact your Canon Customer Support Help Desk as there may be a problem with the camera.



Function	Shooting modes	P	Long Shutter	AUTO	
ISO Speed (p. 72)	 *1	○	—	○	—
		○	—	○	○
		○	○	—	—
		—	—	—	—
		—	—	—	—
Flash (p. 59)		○	—	○	○
		○	○	—	—
		○	○	○	○
		○	○	○	○
Drive Mode (pp. 60, 69, 78)		○	○	—	—
	Self-Timer 	○	○	○	—
		○	○	○	—
Shooting Zone (pp. 64, 65)		○	○	○	—
		○	○	○	—
		○	○	—	—
	All Range	—	—	—	○
Face Select (p. 83)		○	○	○	—
AE/FE Lock (still images) (pp. 86, 87)		○	—	—	—
AE Lock, Exposure Shift (movies) (p. 91)		—	—	—	—
AF Lock (p. 85)		○	○	—	—
LCD Monitor Setting (p. 45)	Display Off	○	○	○	—
	No Information	○	○	○	—
	Information View	○	○	○	○

Function menu					
Exposure Compensation (p. 74)		○	—	—	—
Long Shutter (p. 88)		—	○	—	—
White Balance (p. 73)		—	○	○	○
My Colors (p. 75)		○	○	—	—
		○	○	—	—
Metering System (p. 85)		○	○	○	○
		○	—	—	—
		○	—	—	—
Compression Ratio (still images) (p. 70)		○	○	○	—*2
Number of Recording Pixels (still images) (p. 70)		○	○	○	—*3
		○	○	○	—
Number of Recording Pixels, Frame Rate, Compression (Movie) (p. 90)		—	—	—	—
		—	—	—	—
		—	—	—	—

\*1 Optimum value is automatically set by the camera. \*2 Fixed to  (Fine).

\*3 Fixed to L (Large). \*4 Fixed to M3.

[illegible][illegible]

○ Setting available. — Setting not available.



## ⚙ (Setting) Tab Menu

Item	Options/Summary	Ref. Page
Mute	On/Off*	p. 51
Volume	Off/1/2*/3/4/5	p. 51
Start-up Image	On*/Off	p. 118
Power Saving	Auto Power Down: On*/Off Display Off: 10, 20 or 30 sec./1*, 2 or 3 min.	pp. 42, 118
Date/Time	Date (y/m/d) and time (h/m) settings	p. 18
Format	Formatting memory card, erasing all data	p. 49
File Numbering	Continuous*/Auto Reset	p. 119
Create Folder	Create New Folder/Auto Create	p. 120
Auto Rotate	On*/Off	p. 120
Lens Retract	1 min. */0 sec.	p. 121
Language	Select displayed language	p. 20
Video System	NTSC/PAL	p. 100
Print Method	Auto*/	—
Reset All	Returns camera to default settings	p. 48

\*Default setting



### About Print Method setting

Select when you print an image recorded in the **W** (Widescreen) mode at the full page setting for wide paper using a Canon SELPHY CP750/CP740/CP730/CP720/CP710/CP510 Compact Photo Printer. Since this setting is saved even when the power is turned off, ensure that you return the setting to [Auto] to print other image sizes.

## ▶ (Playback) Tab Menu

Item	Options/Summary	Ref. Page
Slide Show	Automatically plays back images.	p. 98
My Category	Organizes images in categories.	p. 96
Red-Eye Correction	Corrects red-eye in images.	p. 105
Resize	Resizes and saves images.	p. 103
Sound Memo	Records and attaches sound to images.	p. 107
Protect	Protects images.	p. 102
Rotate	Rotates images.	p. 104
Erase all	Erases all unprotected images.	p. 101
Transfer Order	Sets images to transfer to a computer.	p. 109
Resume	Sets the image that displays when resuming playback.	—
Transition		p. 101



## (Print) Tab Menu

Item	Options/Summary	Ref. Page
Print	Prints images set for printing.	p. 26
Select Images & Qty.	Sets images for printing.	p. 113
Select All Images	Sets all images for printing.	p. 113
Clear All Selections	Cancels all settings for printing.	p. 114
Print Settings	Sets the printing style.	p. 114

## Specifications

Camera Effective Pixels	Approx. 10.0 million
Image Sensor	1/2.3.-inch type CCD (Total Pixels: Approx. 10.3 million)
Lens	6.2 (W) – 24.8 (T) mm (35mm film equivalent: 35 (W) – 140 (T) mm) f/2.7 (W) – f/5.6 (T)
Digital Zoom	Approx. 4.0x (Up to approx. 16x in combination with the optical zoom)
Optical Viewfinder	Real-image zoom viewfinder
LCD Monitor	2.5-inch type TFT color LCD, approx. 115,000 dots (Picture coverage 100%)
AF Frame Mode	Face Detect, AiAF (9 points), Center
Focusing Range (from end of lens)	Normal: 50 cm (1.6 ft.) – infinity Macro: 3 – 50 cm (W) (1.2 in. – 1.6 ft. (W)) 30 – 50 cm (T) (1.0 – 1.6 ft. (T)) Infinity: 3 m (10 ft.) – infinity Easy: 3 cm (1.2 in.) – infinity (W), 30 cm (1.0 ft.) – infinity (T) Kids&Pets: 1 m (3.3 ft.) – infinity
Shutter	Mechanical shutter and electronic shutter
Shutter Speeds	1/60 – 1/1600 sec. 15 – 1/1600 sec. (Total shutter speed range. Available range varies by shooting mode.)
Image Stabilization	Lens-shift type
Metering System	Evaluative, Center-weighted average, Spot
Exposure Compensation	±2 stops in 1/3-stop increments
ISO speed (Standard Output Sensitivity, Recommended Exposure Index)	Auto, High ISO Auto, ISO 80/100/200/400/800/1600
White Balance	Auto, Day Light, Cloudy, Tungsten, Fluorescent, Fluorescent H, Custom
Built-in Flash	Auto, On, Off
Built-in Flash Range	30 cm – 4.0 m (1.0 – 13 ft.) (W), 30 cm – 2.0 m (1.0 – 6.6 ft.) (T)
Shooting Modes	P, Auto, Easy, Portrait, Landscape, Night Snapshot, Kids&Pets, Indoor, Special Scene*, Movie** * Night Scene, Sunset, Foliage, Snow, Beach, Fireworks, Aquarium, ISO 3200 ** Standard and Compact
Continuous Shooting	Approx. 1.3 shots/sec. (in Large/Fine mode)
Self-timer	Activates shutter after an approx. 10-sec./approx. 2-sec. delay, Custom
Recording Media	SD memory card, SDHC memory card, MultiMediaCard, MMCplus card, HC MMCplus card
File Format	Design rule for camera file system and DPOF compliant

## Specifications

Data Type	Still images: Exif 2.2 (JPEG) Movies: AVI (Image data: Motion JPEG; Audio data: WAVE (monaural)) Sound memos: WAVE (monaural)
Compression	Superfine, Fine, Normal
Number of Recording Pixels	Still images Large: 3648 x 2736 pixels Medium 1: 2816 x 2112 pixels Medium 2: 2272 x 1704 pixels Medium 3: 1600 x 1200 pixels Small: 640 x 480 pixels Date Stamp: 1600 x 1200 pixels Widescreen: 3648 x 2048 pixels Movies: Standard: 640 x 480 pixels (30 frames/sec.), 640 x 480 pixels (30 frames/sec. LP), 320 x 240 pixels (30 frames/sec.) Compact: 160 x 120 pixels (15 frames/sec.)
Sound (Movie, Sound Memo)	Bit rate: 8 bits Sampling Rate: 11 kHz
Playback Modes	Single/Index/Magnification/Easy/Slide Show/My Category/Red-Eye Correction/Resize/Sound Memo/Protect/Rotate/Focus Check/Jump/Movie Playback
Direct Print	PictBridge compliant, and Canon Direct Print and Bubble Jet Direct compatible
Interface	Hi-Speed USB (mini-B), Audio/Video output (NTSC or PAL selectable, monaural audio)
Communication Settings	MTP, PTP
Power Supplies	2 AA-size alkaline batteries 2 AA-size NiMH batteries NB4-300 (sold separately) AC Adapter Kit ACK800 (sold separately)
Operating Temperatures	0 – 40°C (32 – 104°F)
Operating Humidity	10 – 90%
Dimensions (excluding protrusions)	101.2 x 63.8 x 31.4 mm (3.98 x 2.51 x 1.24 in.)
Weight (camera body only)	Approx. 160 g (5.64 oz.)

## Numerics

3:2 Guide ..... 123

## A

AC adapter kit ..... 126

Accessories ..... 36

AE Lock ..... 86

AF → Auto Focus

AF Frame ..... 22, 80

AF Lock ..... 85

AF-Point Zoom ..... 82

AiAF ..... 81

Aquarium (Scene Mode) ..... 58

Audio ..... 51

Auto Focus → Focus

AV Cable ..... 2, 100

## B

## Batteries

Alkaline Batteries ..... 2, 14

Battery and Charger Kit ..... 38

Charge Indicator ..... 16

NiMH Battery (sold separately) .  
16

Power Saving ..... 42, 118

Rechargeable Batteries (Date/  
Time Battery) ..... 19

Beach (Scene Mode) ..... 57

Black and White Images ..... 75

## C

Camera Shake ..... 59, 124

Components Guide ..... 40

Compression → Image Quality

Continuous Shooting ..... 69

## D

Date and Time → Date/Time

Date/Time ..... 18

Adding to Image ..... 63

Changing ..... 19

Date/Time Battery ..... 19

Setting ..... 18

Default Settings ..... 48

Deleting → Erasing

Digital Camera Solution Disk ..... 2

Digital Tele-Converter ..... 62

Digital Zoom ..... 61

Direct Print ..... 27

Direct Print User Guide ..... 2

Display Language ..... 20

Display Overlay ..... 123

DPOF ..... 109, 111

## E

Easy Mode ..... 24, 54

## Editing

Red-Eye Correction ..... 105

Resizing (Making Images Smaller)  
..... 103

Rotating ..... 104

Enlarged Display ..... 82

## Equipment

Default Settings ..... 48

Holding the Camera ..... 13

Erasing All Images ..... 101

Erasing Images ..... 25

Error Messages ..... 132

## Exposure

AE Lock ..... 86

Correction ..... 74

FE Lock ..... 87

## F

Face Detect ..... 80

Face Select ..... 83

Factory Settings → Default Settings

FE Lock ..... 87

File No ..... 119

Fireworks (Scene Mode) ..... 58

## Flash

Flash Off ..... 59

Flash On ..... 59

Supplementary Flash ..... 126

Focus ..... 22

AF Frame ..... 80

Focus Check ..... 84

Focus Lock ..... 76

Foliage (Scene Mode) ..... 57

Format → Memory Cards - Format,

Equipment - Default Settings

Formatting (Memory Card) ..... 49

## FUNC. Menu

Basic List ..... 134

Basic Operations ..... 46

## G

Grid Lines ..... 123

## H

High Speed (ISO) ..... 58, 72

High-Power Flash ..... 126

Histogram ..... 44

Household Power ..... 126

## I

Image Quality (Compression Ratio)

70

## Images

Display Time ..... 52

Editing → Editing

Erasing Images ..... 25

Playback → Viewing ..... 24

Indicator ..... 41, 42

Indoor (Scene Mode) ..... 56

Infinity ..... 65

Interface Cable ..... 26, 31

ISO Speed ..... 72

ISO3200 (Scene Mode) ..... 58

## K

Kids&amp;Pets (Scene Mode) ..... 55

## L

L size ..... 71

Lamp ..... 40, 122

Landscape (Scene Mode) ..... 55

LCD monitor → Screen

Long Shutter Mode ..... 88

## M

Macro ..... 64

Magnifying Images ..... 97

## Memory Cards

Available Shots ..... 17, 71

Format ..... 49

Menu Functions (Basic Operations)

47

Menus ..... 136

Metering Mode ..... 85

MMCplus/HC MMCplus Memory

Card, MultiMedia card → Memory

Cards

Mode Dial ..... 40

Movies ..... 28

Image Quality (Frame Rate) 91

Mode ..... 90

Recording Pixels ..... 90



Shooting Time .....	29, 91
Viewing (Playback) .....	30
MultiMedia card → Memory Cards	
My Category .....	96
My Colors .....	75

## N

Night Scene (Scene Mode) .....	57
Night Snapshot (Scene Mode) .....	55
Number of Shots .....	17

## P

PictBridge .....	26, 27
Playback Button .....	41
Playback → Viewing	
Portrait (Scene Mode) .....	55
Postcard Size .....	71
Power Button .....	22
Power → Batteries	
Power Saving .....	42, 118
Print List .....	111
Print Settings (DPOF) .....	114
Print/Share Button .....	26, 124
Printer .....	26, 27, 112
Printing .....	26
Program AE .....	68
Protect .....	102

## R

Recording Pixels (Image Size). 70	
Red-Eye .....	
Auto Correction .....	122
Red-Eye Correction .....	105
Reduction .....	122
Resizing (Making Images Smaller)	
103 .....	
Rotating Images .....	104

## S

Safety Zoom .....	61
Screen	
Information Displayed .....	43
Language .....	20
Menu Operations .....	46, 47
Switching the Display .....	45
SD/SDHC memory cards → Memo-	
ry Cards	
Self-Timer	
Changing Delay and Number of	
Shots .....	78
Shoot .....	60
Sepia Tones .....	75
Shooting Date and Time → Date/	
Time	
Shooting Using a TV .....	77
Shutter Button .....	21
Slide Show .....	98
Snow (Scene Mode) .....	57
Software	
Digital Camera Solution Disk .	2
Software Starter Guide .....	2
Transferring Images to a Compu-	
ter .....	31
Sound .....	51
Sound Memos .....	107
Strap .....	2, 13
Sunset (Scene Mode) .....	57
Supplementary Flash .....	126

## T

Terminal .....	26, 33, 100, 126
Tone (White Balance) .....	73
Transferring Images to a Computer	
31, 34, 108, 109	
Transition Effects .....	98
Troubleshooting (You Think There	

Is a Problem) .....	128
---------------------	-----

## V

Video → Movies	
Viewfinder .....	41, 77
Viewing (Playback) .....	93
AF-Point Zoom .....	82
Enlarged Display .....	97
Index Playback .....	94
Single Image Playback .....	24
Slide Show .....	98
Viewing Images on a TV ....	100

## W

White Balance .....	73
Widescreen .....	71

## Z

Zoom .....	22, 28, 61
------------	------------

## Trademark Acknowledgments

- The SDHC logo is a trademark.

## Disclaimer

- Reprinting, transmitting, or storing in a retrieval system any part of this guide without the permission of Canon is prohibited.
- Canon reserves the right to change the contents of this guide at any time without prior notice.
- Illustrations and screenshots in this guide may differ slightly from the actual equipment.
- Every effort has been made to ensure that the information contained in this guide is accurate and complete. However, if you notice any errors or omissions, please contact the Canon customer service center indicated on the customer support list included with the product.
- The above items notwithstanding, Canon accepts no liability for damages due to mistaken operation of the products.

### **For CA, USA only**

Included lithium battery contains Perchlorate Material - special handling may apply.  
See [www.dtsc.ca.gov/hazardouswaste/perchlorate/](http://www.dtsc.ca.gov/hazardouswaste/perchlorate/) for details.